

## 23c, 24ci, 30ci, 18si, 30si, Xtrafast 96, Xtrafast 120 and Xtramax

### HORIZONTAL TELESCOPIC TOP REAR FLUE OPTIONS

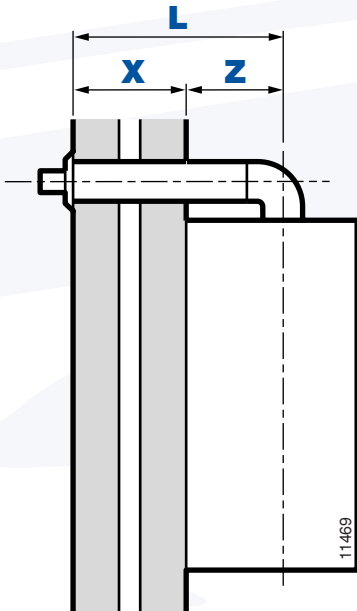

**L** = Flue length, measured from outside wall face to centre line of flue outlet.

If **L** is between 425mm and 630 mm then only the horizontal telescopic top flue, A2004500, is required. If **L** is greater than 630mm then extensions are required. If **L** is less than 425mm then use the horizontal top flue, 86285H, which can be cut to suit a minimum wall thickness of 75mm.

**X** = Wall thickness.

**Z** = Distance from centre line of flue outlet to inside wall face.

For each additional 90° or 2 x 45° bends fitted the maximum flue length must be reduced by 1m.

The maximum flue length with extensions must not be exceeded (refer to **L** in table below).

A	Model	L Max with extensions	X (mm)		Z	A Horizontal telescopic top flue A2004500
			Min	Max		
	23c	3.0m	261	465	165mm	
	24ci	3.5m	242	446	184mm	
	30ci	3.5m	194	398	232mm	
	30si	3.5m	194	398	232mm	
	18si	3.5m	242	446	184mm	
	Xtrafast 96	3.5m	192	396	234mm	
	Xtrafast 120	2.5m	192	396	234mm	
	Xtramax	3.5m	192	396	234mm	

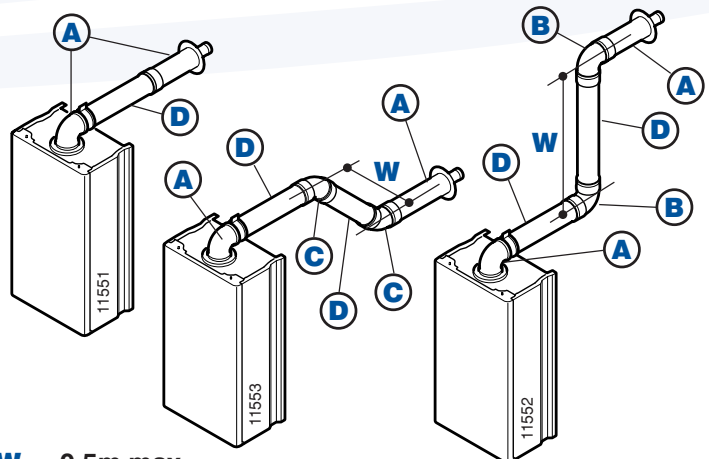
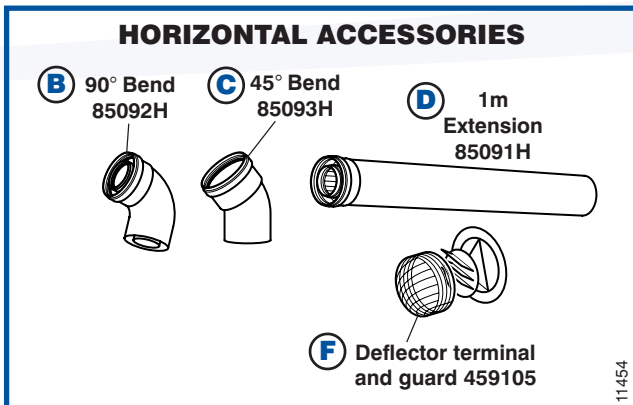

**W** = 0.5m max.

Flueing examples using extensions and bends. Many others are also possible.

# HORIZONTAL TELESCOPIC TOP SIDE FLUE OPTIONS

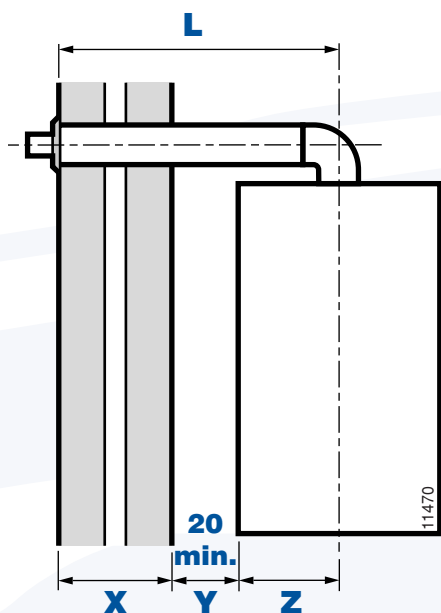

**L** = Flue length, measured from outside wall face to centre line of flue outlet.

If **L** is between 425mm and 630mm then only the horizontal telescopic top flue, A2004500, is required.

If **L** is greater than 630mm then extensions are required.

If **L** is less than 425mm then use the horizontal top flue, 86285H, which can be cut to suit a minimum wall thickness of 75mm.

**X** = Wall thickness.

**Y** = Distance from the side of the boiler to the inside wall face.

**Z** = Distance from centre line of flue outlet to side of boiler.

For each additional 90° or 2 x 45° bends fitted the maximum flue length must be reduced by 1m.

The maximum flue length with extensions must not be exceeded (refer to **L** in table below).

Model	L Max with extensions	X (mm)		Z	A Horizontal telescopic top flue A2004500
		Min	Max		
23c	3.0m	201	405	205mm	
24ci	3.5m	201	405	205mm	
30ci	3.5m	181	385	225mm	
30si	3.5m	181	385	225mm	
18si	3.5m	201	405	205mm	
Xtrafast 96	3.5m	171	375	235mm	
Xtrafast 120	2.5m	130	334	276mm	
Xtramax					
left	3.5m	275	479	131mm	
right	3.5m	0	141	469mm	

### HORIZONTAL ACCESSORIES

**B** 90° Bend 85092H

**C** 45° Bend 85093H

**D** 1m Extension 85091H

**F** Deflector terminal and guard 459105

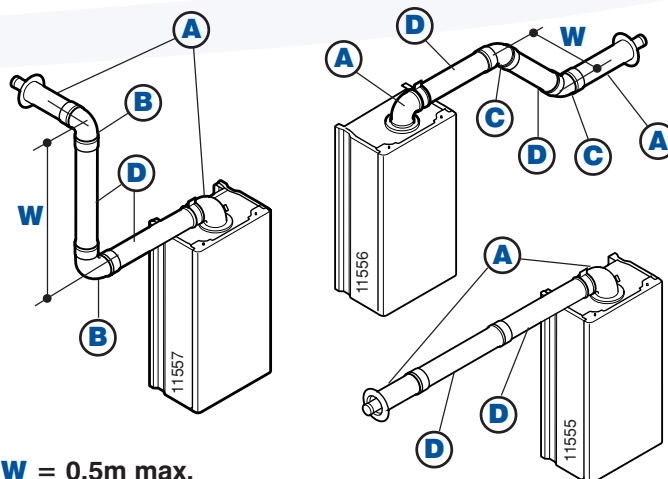

**W** = 0.5m max.

Flueing examples using extensions and bends

# ELEVATED HORIZONTAL TELESCOPIC TOP FLUE OPTIONS

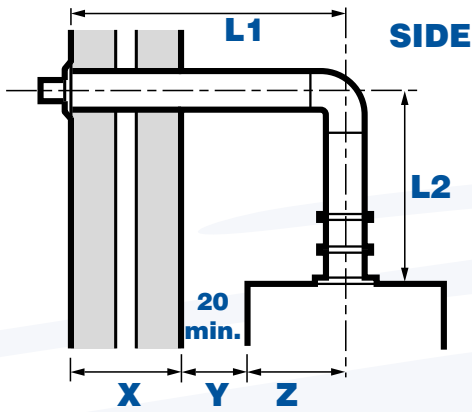

**L1** = Measured from the vertical flue centre line to the outside wall face.

**L2** = Measured from the top of the boiler to the horizontal flue centre line (max 0.5m).

**L = L1 + L2** = The maximum flue length with extensions, measured from the top of the boiler to the outside wall face.

If more than 1 x 90° bend or 2 x 45° bends are needed then for each additional 90° bend or 2 x 45° bends fitted the maximum flue length must be reduced by 1m.

The maximum flue length with extensions must not be exceeded (refer to **L** in table below).

**X** = Wall thickness.

**Y** = Distance from the side of the boiler to the inside wall face.

**Z** = Distance from centre line of flue outlet to the side or rear of the boiler.

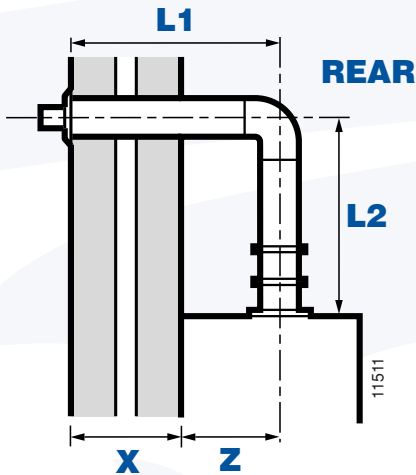

**A** Horizontal telescopic top flue A2004500

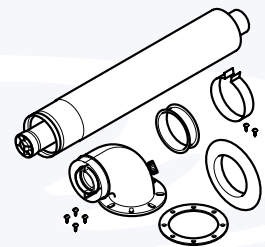

Model	L Max with extensions	SIDE X mm		REAR X mm		SIDE Z	REAR Z	Description of parts	Part number
		Min	Max	Min	Max				
23c	3.0m	201	435	261	495	205mm	165mm	<b>A</b> Horizontal Telescopic Top Flue <b>B</b> 90° Bend <b>D</b> 1m Extension <b>E</b> Adaptor elevated flue	A2004500
24ci	3.5m	201	435	242	476	205mm	184mm		
30ci	3.5m	181	415	194	398	225mm	232mm		
30ci	3.5m	181	415	194	398	225mm	232mm		
18si	3.5m	201	435	242	476	205mm	184mm		
Xtrafast 96	3.5m	171	405	192	426	235mm	234mm		
Xtrafast 120	2.5m	130	364	192	426	276mm	234mm		
Xtramax									
left	3.5m	315	509	192	426	131mm	234mm		
right	3.5m	0	171	192	426	469mm	234mm		

### ELEVATED HORIZONTAL ACCESSORIES

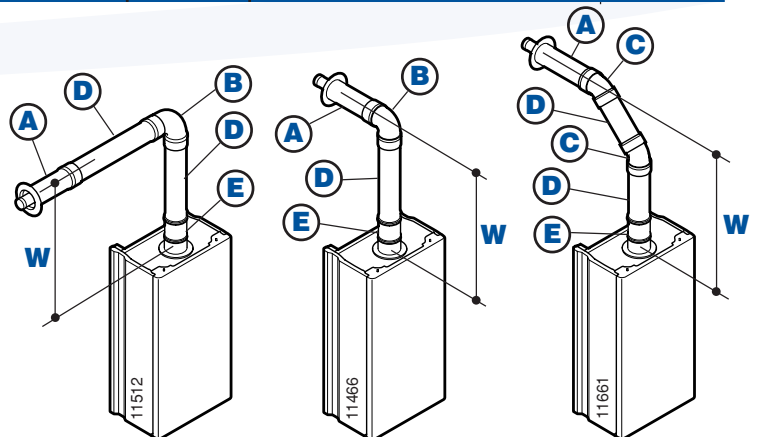

**W** = 0.5m max.

Flueing examples using extensions and bends

# VERTICAL FLUE OPTIONS

**L** = Flue length, measured from the top of the boiler to the underside of the roof flashing.

If flue length is greater than 3m the condensate trap must be fitted. Flue must allow condensate to run back to the boiler when trap is fitted.

For each 90° or 2 x 45° bends fitted the maximum flue length must be reduced by 1m.

The maximum flue length with extensions must not be exceeded (refer to **L** in table below).

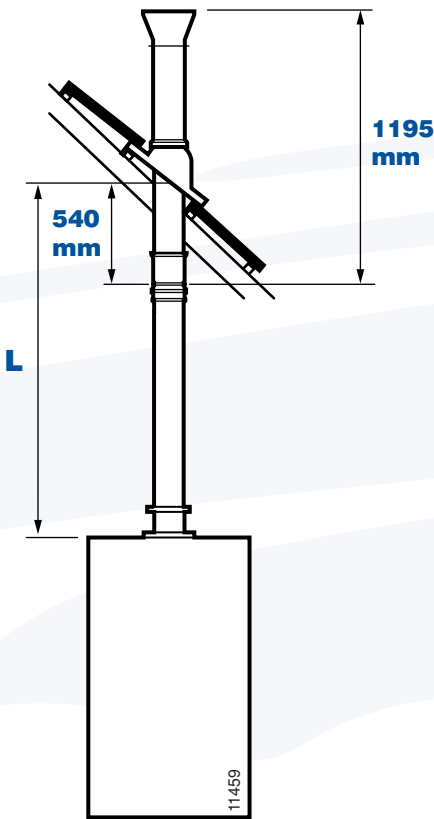

**A** Vertical flue adaptor including condensate trap 459106

**B** Vertical roof terminal 456045

	Model	L Max with extensions	Description of parts	Part number
	23c	9.54m	<b>A</b> Vertical flue adaptor	459106
	24ci	12.54m	<b>B</b> Vertical roof terminal	456045
	30ci	8.54m	<b>C</b> 1M Extension	456057
	30si	8.54m	<b>E or G</b> Roof flashing	456061 or 456059
	18si	12.54m	<b>F</b> Adjustable pipe	456058
	Xtrafast 96	12.04m		
	Xtrafast 120	8.04m		
	Xtramax	12.04m		

### VERTICAL FLUE ACCESSORIES

**F** Adjustable pipe 0 to 270mm 456058  
(must be used with 1m Extension 456057)

**E** Flat roof flashing 456061

**G** Pitched roof flashing 456059

**D** Fixing bracket (3off) 456073

**C** 1m Extension 456057

**H** 45° Bend 456068

**J** 90° Bend 456067

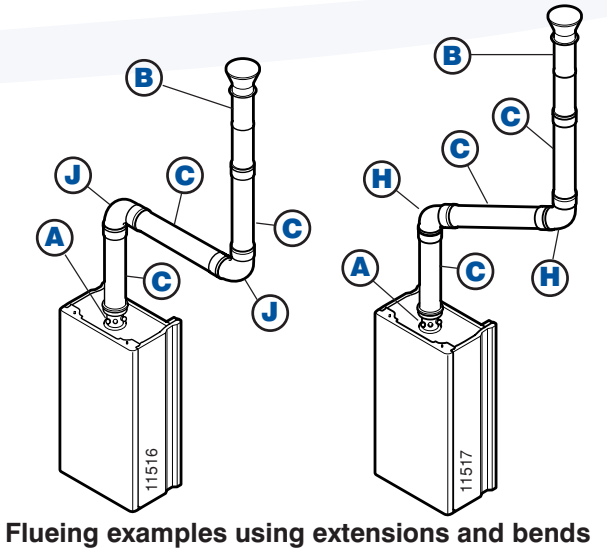

Flueing examples using extensions and bends

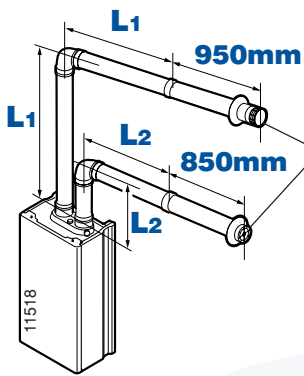

# TWIN FLUE OPTIONS

$L = L_1 + L_2$  Maximum available combined flue length ( $L_1$  air inlet and  $L_2$  flue outlet), measured from top of the boiler (not including the terminal).

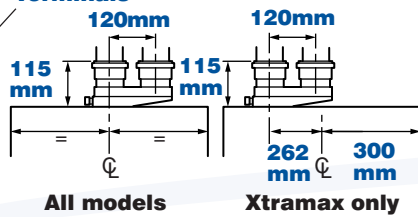

For each 90° or 2 x 45° bends fitted the maximum flue length must be reduced by 1m.

Option 1	Model	$L = L_1$ air + $L_2$ flue Max combined flue length	Description of parts	Part number
		23c	18m	<ul style="list-style-type: none"> <li><b>P</b> Twin flue adaptor</li> <li><b>B</b> 1m Extension</li> <li><b>D</b> Vertical roof terminal</li> <li><b>G</b> 45° Bend</li> <li><b>M</b> Twin pipe to concentric adaptor</li> </ul>
24ci	38m	459115		
30ci	30m	456045		
30si	30m	456063		
18si	38m	456062		
Xtrafast 96	21m horizontal 25m vertical			
Xtrafast 120	15m horizontal 17m vertical			
Xtramax	25m			

Option 2	Model	$L = L_1$ air + $L_2$ flue Max combined flue length	Description of parts	Part number
		23c	18m	<ul style="list-style-type: none"> <li><b>A</b> Twin flue kit</li> <li><b>B</b> 1m Extension</li> <li><b>D</b> Vertical roof terminal</li> <li><b>E</b> Single pipe adaptor</li> </ul>
24ci	38m	459115		
30ci	30m	456045		
30si	30m	456065		
18si	38m			
Xtrafast 96	21m horizontal 25m vertical			
Xtrafast 120	15m horizontal 17m vertical			
Xtramax	25m			

Option 3	Model	$L = L_1$ air + $L_2$ flue Max combined flue length	Description of parts	Part number
		23c	18m	<ul style="list-style-type: none"> <li><b>P</b> Twin flue adaptor</li> <li><b>B</b> 1m Extension</li> <li><b>K</b> 90° Bend</li> <li><b>M</b> Twin pipe to concentric adaptor</li> <li><b>N</b> Concentric horizontal terminal</li> </ul>
24ci	38m	459115		
30ci	30m	456064		
30si	30m	456062		
18si	38m			
Xtrafast 96	21m horizontal 25m vertical			
Xtrafast 120	15m horizontal 17m vertical			
Xtramax	25m			

Option 4	Model	$L = L_1$ air + $L_2$ flue Max combined flue length	Description of parts	Part number
		23c	18m	<ul style="list-style-type: none"> <li><b>A</b> Twin flue kit</li> <li><b>B</b> 1m Extension</li> </ul>
24ci	38m	459115		
30ci	30m			
30si	30m			
18si	38m			
Xtrafast 96	21m horizontal 25m vertical			
Xtrafast 120	15m horizontal 17m vertical			
Xtramax	25m			

# TWIN FLUE OPTIONS

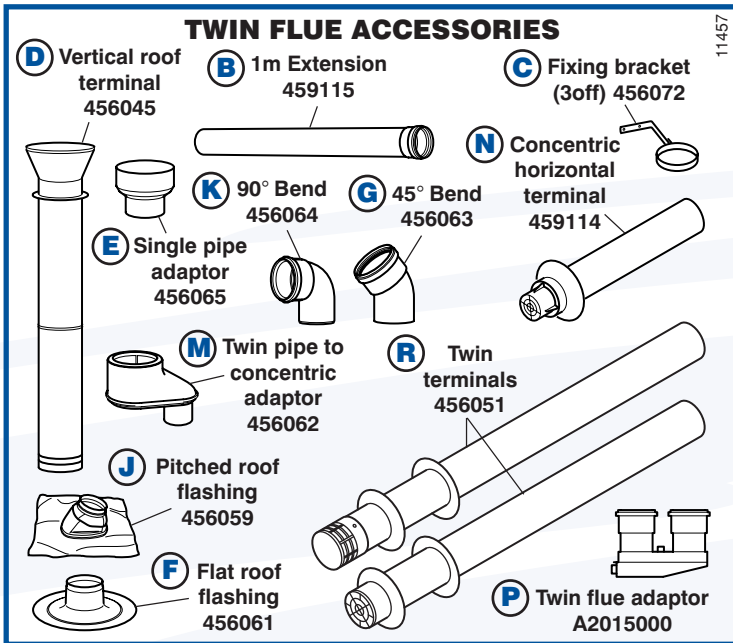

Air inlet and flue outlet terminals must be installed so that they are exposed to external air.

If **L** 2 flue outlet is greater than 3m the condensate trap must be fitted.

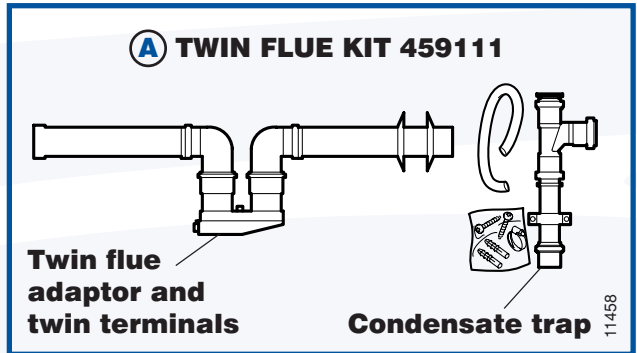

# REAR FLUE OPTIONS 30ci and 30si Only

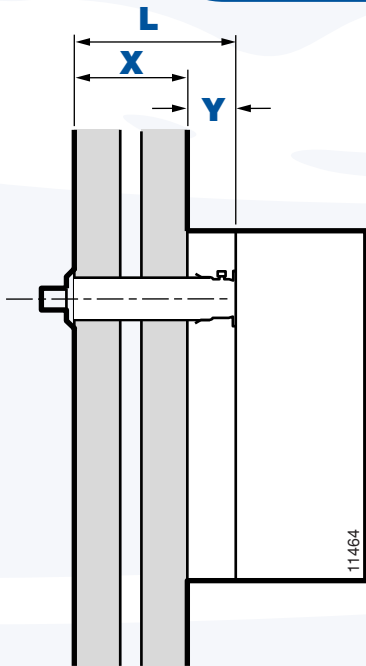

**L** = Flue length, measured from the rear of the boiler to outside wall face.

To achieve the max flue length of 1.5m an extension must be used (85091H).

**X** = Wall thickness.

**Y** = 115mm

The maximum flue length with extensions must not be exceeded (refer to **L** in table below).



	Model	L Max with extensions	X (mm)		Description of parts	Part number
			Min	Max		
11522	30ci	1.5m	75	540	A Rear flue kit	A2009700
	30si	1.5m	75	540		

Literature: Tel: 01773 596105 Fax: 01773 828555  
 After Sales Service: Tel: 01773 828100 Fax: 01773 828070  
 Technical Advice: Tel: 01773 828300 Fax: 01773 828070

Visit [www.glow-worm.co.uk](http://www.glow-worm.co.uk) to view and download technical data



Hepworth Heating Ltd.  
 Nottingham Road, Belper,  
 Derbyshire. DE56 1JT

The illustrations show our products as realistically as possible, however the limitations of photography and printing may result in goods varying slightly from the illustration. Hepworth Heating Ltd. pursue a policy of continual improvement in design and performance of its products. In pursuance of the policy we reserve the right to alter specification and design. The statutory rights of the consumer are not affected.