

# Specification for Flue Options

NOTTINGHAM ROAD,  
BELPER, DERBYSHIRE DE56 1JT  
TELEPHONE 0870 606 4351  
FACSIMILE (01773) 820569  
[www.saunier-duval.co.uk](http://www.saunier-duval.co.uk)

TECHNICAL HELPLINE  
**01773 828400**  
IN WARRANTY HELPLINE  
**01773 525914**



*The mark of quality for domestic heating*



C.E. British Gas Service Listed.  
Water Research Council Approved.  
Saunier Duval pursues a policy of continuous  
product improvement and reserves  
the right to alter specification and  
design without prior notice.

**Thema Classic**

F24e, F30e, F35e  
F24e PLUS, F30e PLUS  
F18e SB, F30e SB

**Iso max**

F28e

**Opalia Water Heater**

x13

**Contents**

**Standard Efficiency Combis, System Boilers and Water Heater**

- Horizontal Telescopic Top Rear Options 3
- Horizontal Telescopic Top Side Options 4
- Elevated Horizontal Telescopic Top Flue Options 5
- Vertical Flue Options 6
- Twin Flue Options 7 8
- Rear Flue Options F30e, F35e, F30e SB, F24e PLUS and F30e PLUS 9

**High Efficiency Condensing Boilers**

- Horizontal Flue Options 10
- Vertical Flue Options 11
- Twin Flue Options 12
- Accessories 13

**Wall Hung Cast Iron Boiler**

- Horizontal Flue Options models 40 - 80 14 15
- Vertical Flue Options models 40 - 80 16
- Easi-Vent Flue Options models 40 - 80 17
- Flue Options 18
- Horizontal Flue Options model 100/120 19
- Vertical Flue Options model 100/120 20
- Flue Options Accessories model 100/120 21
- Vertical Flue Accessories model 100/120 22
- Fanned Flue Terminal Positions 22

**Training and Support to help you**

23

**HORIZONTAL TELESCOPIC TOP REAR OPTIONS**

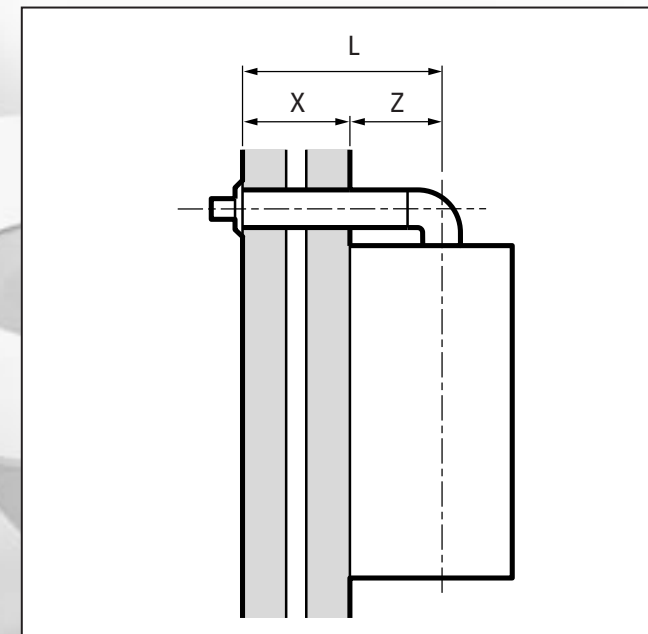

L = Flue length, measured from outside wall face to centre line of flue outlet.  
 If L is between 425mm and 630mm then only the horizontal telescopic top flue, A2004500, is required.  
 If L is greater than 630mm then extensions are required.  
 If L is less than 425mm then use the horizontal top flue, 86285H, which can be cut to suit a minimum wall thickness of 75mm.  
 X = Wall thickness  
 Z = Distance from centre line of flue outlet to inside wall face.  
**For each additional 90° or 2 x 45° bends fitted the maximum flue length must be reduced by 1m.**  
 The maximum flue length with extensions must not be exceeded (refer to L in table below).

MODEL	L MAX WITH EXTENSIONS	SIDE X MM		Z	
		MIN	MAX		
F24e	3.5m	242	446	184mm	<p>1 Horizontal telescopic top flue A2004500</p>
F30e	3.5m	194	398	232mm	
F35e	2.5m	194	398	232mm	
F24e PLUS	3.5m	194	398	232mm	
F30e PLUS	3.5m	194	398	232mm	
F18e SB	3.5m	242	446	184mm	
F30e SB	3.5m	194	398	232mm	
Iso max	3.5m	192	396	234mm	
Opalia x13	3.0m	292	496	134mm	

**HORIZONTAL ACCESSORIES**

- 2 90° Bend 85092H
- 3 45° Bend 85093H
- 4 1m Extension 85091H

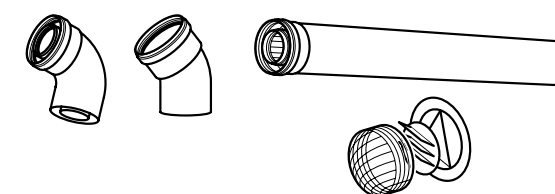

6 Deflector terminal and guard 08537300

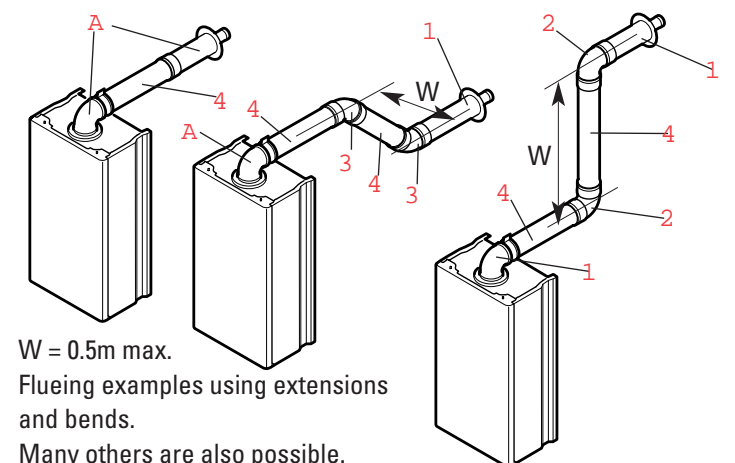

W = 0.5m max.  
 Flueing examples using extensions and bends.  
 Many others are also possible.

## HORIZONTAL TELESCOPIC TOP SIDE OPTIONS

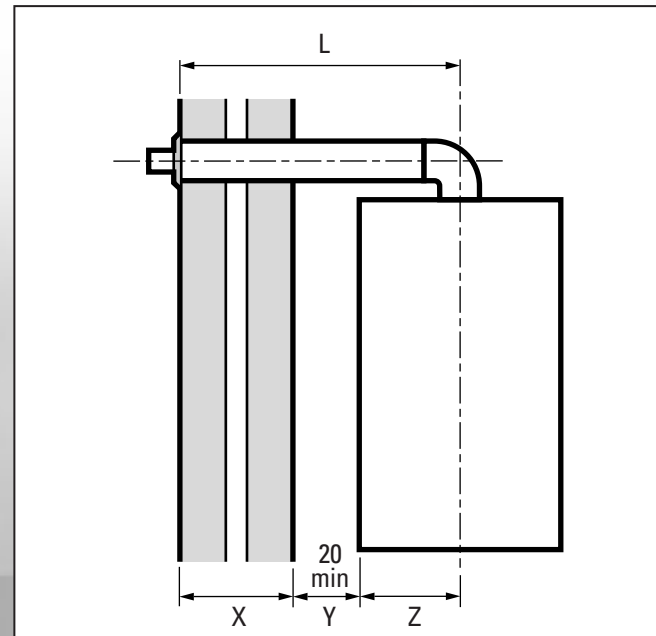

L = Flue length, measured from outside wall face to centre line of flue outlet

If L is between 425mm and 630mm then only the horizontal telescopic top flue, A2004500, is required.

If L is greater than 630mm then extensions are required.

**If L is less than 425mm then use the horizontal top flue, 86285H, which can be cut to suit minimum wall thickness of 75mm.**

X = Wall thickness

Z = Distance from centre line of flue outlet to inside wall face.

**For each additional 90° or 2 x 45° bends fitted the maximum flue length must be reduced by 1m.**

The maximum flue length with extensions must not be exceeded (refer to L in table below).

## ELEVATED HORIZONTAL TELESCOPIC TOP FLUE OPTIONS

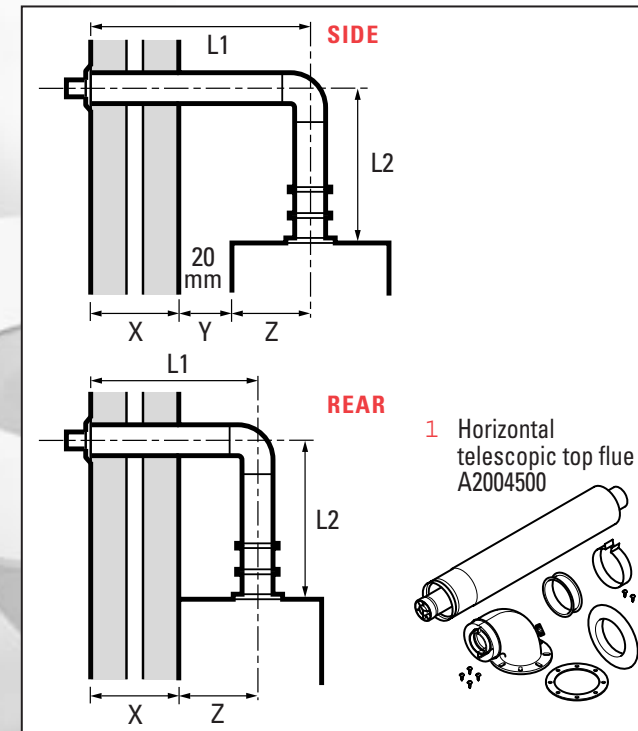

L1 = Measured from the vertical flue centre line to the outside wall face.

L2 = Measured from the top of the boiler to the horizontal flue centre line (max 0.5m).

L = L1 + L2 = The maximum flue length with extensions, measured from the top of the boiler to the outside wall face.

**If more than 1 x 90° or 2 x 45° bends are needed then for additional 90° bend or 2 x 45° bends fitted the maximum flue length must be reduced by 1m.**

The maximum flue length with extensions must not be exceeded (refer to L in table below).

X = Wall thickness

Y = Distance from the side of the boiler to the inside wall face.

Z = Distance from centre line of flue outlet to the side or rear of the boiler.

MODEL	L MAX WITH EXTENSIONS	SIDE X MM		Z	1 Horizontal telescopic top flue A2004500
		MIN	MAX		
F24e	3.5m	201	405	205mm	
F30e	3.5m	181	385	225mm	
F35e	2.5m	181	385	225mm	
F24e PLUS	3.5m	181	385	225mm	
F30e PLUS	3.5m	181	385	225mm	
F18e SB	3.5m	201	405	205mm	
F30e SB	3.5m	181	385	225mm	
Isomax left	3.5m	275	479	131mm	
Isomax right	3.5m	0	141	469mm	
Opalia x13	3.0m	211	415	195mm	

MODEL	L MAX WITH EXTENSIONS	SIDE X MM		REAR X MM		SIDE Z	REAR Z	DESCRIPTION OF PARTS	PART NUMBER
		MIN	MAX	MIN	MAX				
F24e	3.5m	201	435	242	476	205mm	184mm	1 Horizontal telescopic top flue	A2004500
F30e	3.5m	181	415	194	398	225mm	232mm	2 90° Bend	85092H
F35e	2.5m	181	415	194	398	225mm	232mm	4 1m Extension	85091H
F24e PLUS	3.5m	181	415	194	398	225mm	232mm	5 Adaptor elevated flue	85095H
F30e PLUS	3.5m	181	415	194	398	225mm	232mm		
F18e SB	3.5m	201	435	242	476	205mm	184mm		
F30e SB	3.5m	181	415	194	398	225mm	232mm		
Isomax left	3.5m	315	509	192	426	131mm	234mm		
Isomax right	3.5m	0	171	192	426	469mm	234mm		
Opalia x13	3.0m	211	445	292	526	195mm	134mm		

### HORIZONTAL ACCESSORIES

- 2 90° Bend 85092H
- 3 45° Bend 85093H
- 4 1m Extension 85091H

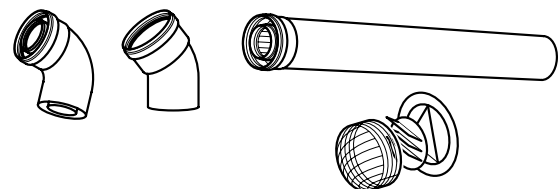

- 6 Deflector terminal and guard 08537300

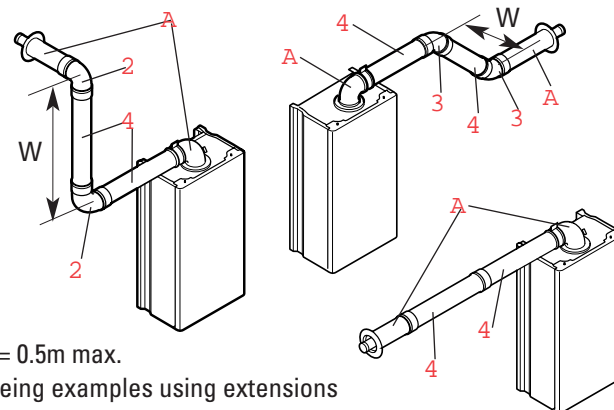

W = 0.5m max.  
Flueing examples using extensions and bends.

### ELEVATED HORIZONTAL ACCESSORIES

- 2 90° Bend 85092H
- 3 45° Bend 85093H
- 4 1m Extension 85091H

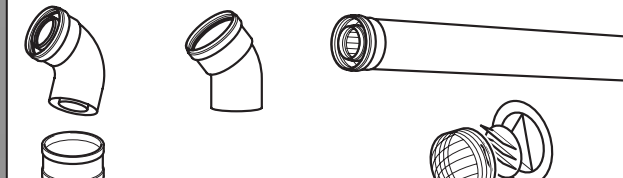

- 5 Adaptor elevated flue 85095H

- 6 Deflector terminal and guard 08537300

W = 0.5m max.  
Flueing examples using extensions and bends

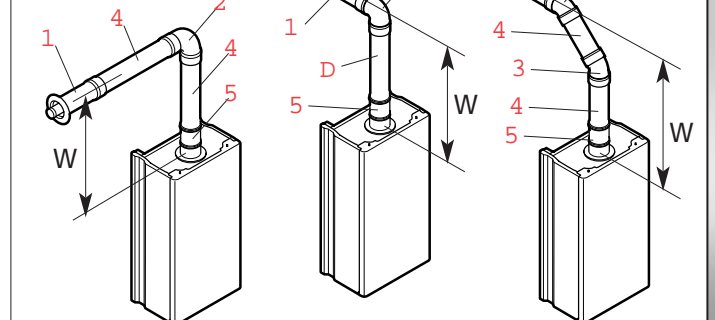

## VERTICAL FLUE OPTIONS

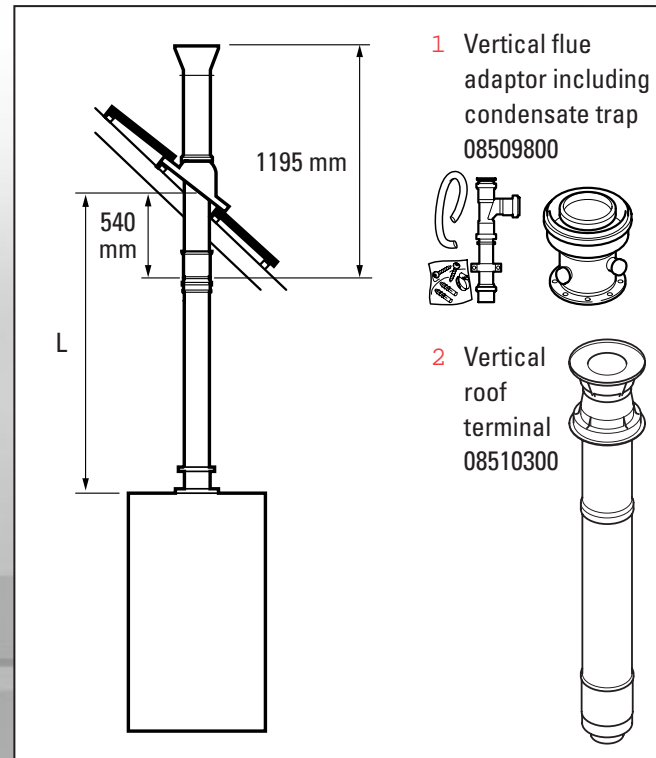

L = Flue length, measured from the top of the boiler to the underside of the roof flashing

If flue length is greater than 3m the condensate trap must be fitted. Flue must allow condensate to run back to the boiler when trap is fitted.

**For each 90° or 2 x 45° bends fitted the maximum flue length must be reduced by 1m.**

The maximum flue length must with extensions must not be exceeded (refer to L in table below).

MODEL	L MAX WITH EXTENSIONS	DESCRIPTION OF PARTS	PART NUMBER
F24e	12.54m	1 Vertical flue adaptor	08509800
F30e	8.54m	2 Vertical roof terminal	08510300
F35e	6.54m	3 1m Extension	08509900
F24e PLUS	8.54m	4 Fixing bracket	08512000
F30e PLUS	8.54m	or 5 Flat roof flashing	08510700
F18e SB	12.54m	6 Adjustable pipe	08510000
F30e SB	8.54m		
Isomax	12.04m		

### VERTICAL FLUE ACCESSORIES

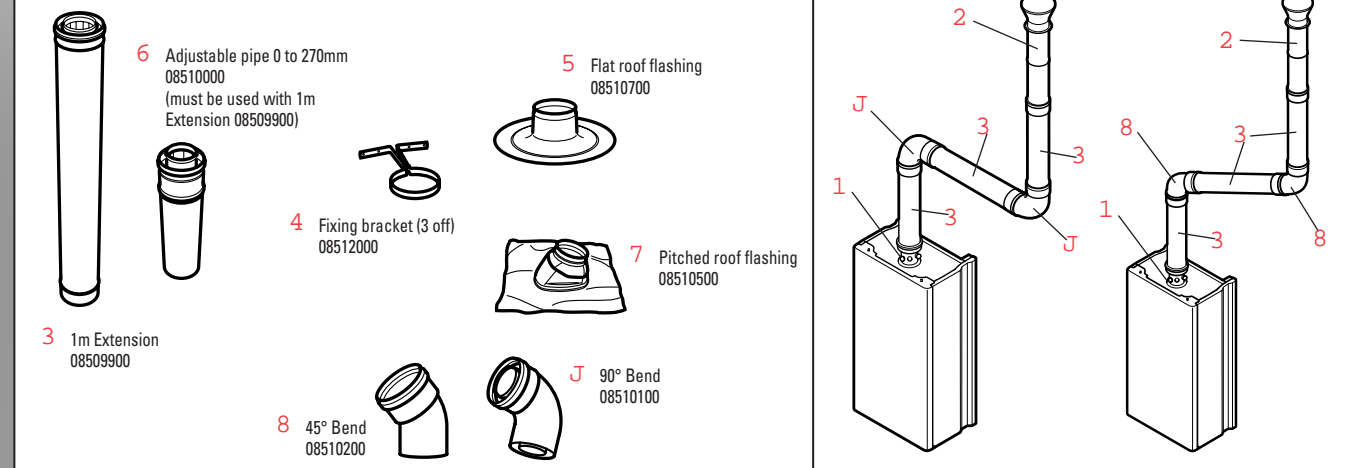

## TWIN FLUE OPTIONS

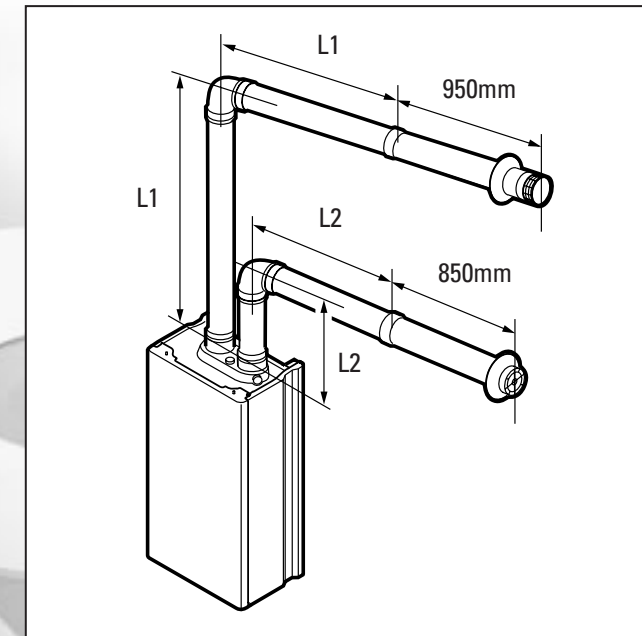

L = L1 + L2 Maximum available combined flue length (L1 air inlet and L2 flue outlet), measured from top of the boiler (not including the terminal)

**For each 90° or 2 x 45° bends fitted the maximum flue length must be reduced by 1m.**

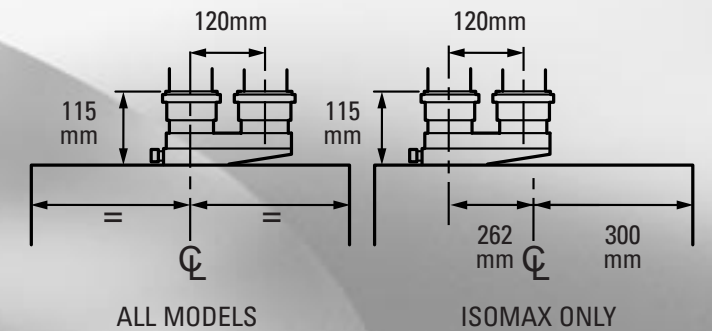

OPTION 1	MODEL	L = L1 air + L2 flue Max combined flue length	DESCRIPTION OF PARTS REQUIRED	PART NUMBER
	F24e	38m	P Twin flue adaptor	08567700
	F30e	30m	2 1m Extension	08539000
	F35e	14m	4 Vertical roof terminal	08510300
	F24e PLUS	30m	7 45° Bend	08538800
	F30e PLUS	30m	M Twin pipe to concentric adaptor	08511800
	F18e SB	38m		
	F30e SB	30m		
	Isomax	25m		

OPTION 2	MODEL	L = L1 air + L2 flue Max combined flue length	DESCRIPTION OF PARTS REQUIRED	PART NUMBER
	F24e	38m	1 Twin flue kit	08567900
	F30e	30m	2 1m Extension	08539000
	F35e	14m	4 Vertical roof terminal	08510300
	F24e PLUS	30m	5 Single pipe adaptor	08511900
	F30e PLUS	30m	6 90° Bend	08538700
	F18e SB	38m		
	F30e SB	30m		
	Isomax	25m		



OPTION 3	MODEL	L = L1 air + L2 flue Max combined flue length	DESCRIPTION OF PARTS REQUIRED	PART NUMBER
	F24e	38m	P Twin flue adaptor	08567700
	F30e	30m	2 1m Extension	08539000
	F35e	14m	K 90° Bend	08538700
	F24e PLUS	30m	M Twin pipe to concentric adaptor	08511800
	F30e PLUS	30m	N Concentric horizontal terminal	08584900
	F18e SB	38m		
	F30e SB	30m		
	Isomax	25m		

OPTION 4	MODEL	L = L1 air + L2 flue Max combined flue length	DESCRIPTION OF PARTS REQUIRED	PART NUMBER
	F24e	38m	1 Twin flue kit	08567900
	F30e	30m	2 1m Extension	08539000
	F35e	14m		
	F24e PLUS	30m		
	F30e PLUS	30m		
	F18e SB	38m		
	F30e SB	30m		
	Isomax	25m		

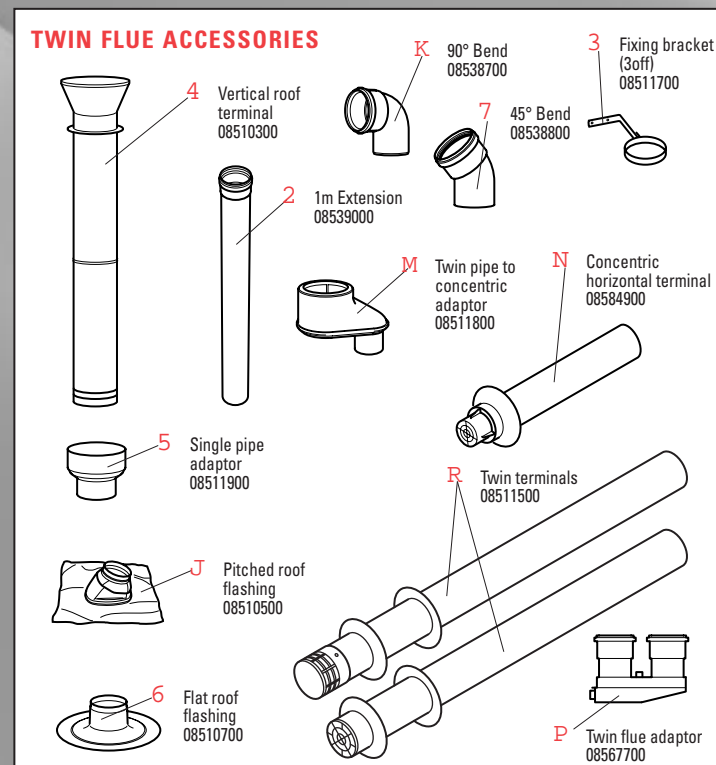

Air inlet and flue outlet terminals must be installed so that they are exposed to external air. If L2 flue outlet is greater than 3m the condensate trap must be fitted.

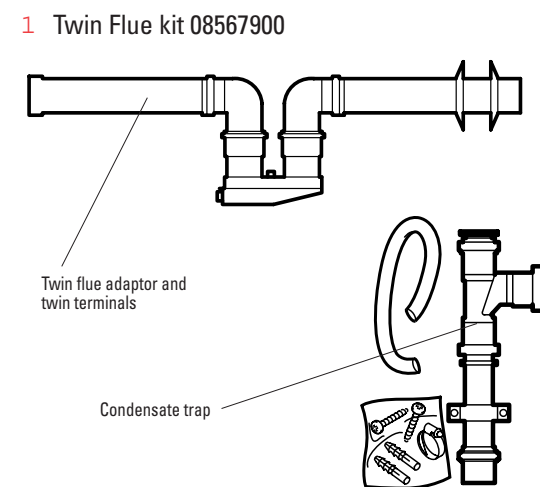

## REAR FLUE OPTIONS F30e, F35e, F30e SB, F24e PLUS and F30e PLUS

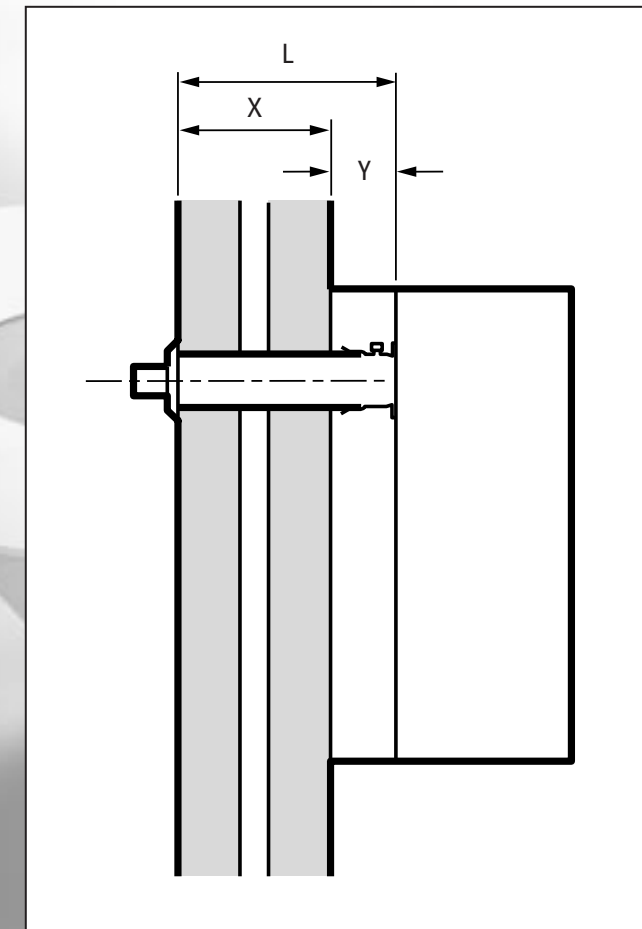

L = Flue length, measured from the rear of the boiler to outside wall face.

To achieve the max flue length of 1.5m an extension must be used (85091H).

X = Wall thickness

Y = 115mm

The maximum flue length with extensions must not be exceeded (refer to L in table below).

	MODEL	L MAX WITH EXTENSIONS	SIDE X MM		DESCRIPTION	PART NUMBER
			MIN	MAX		
	F30e	1.5m	75	540	1 Rear flue kit	A20097
	F35e	1.5m	75	540		
	F24e PLUS	1.5m	75	540		
	F30e PLUS	1.5m	75	540		
	F30e SB	1.5m	75	540		

## HORIZONTAL FLUE OPTIONS

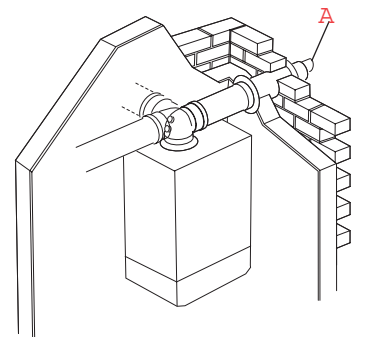
STANDARD HORIZONTAL FLUE	MODEL	MAX LENGTH OF STANDARD PACK	DESCRIPTION OF PARTS REQUIRED	PART NUMBER
	ALL	755mm	A Standard Horizontal Flue Kit	A2024800

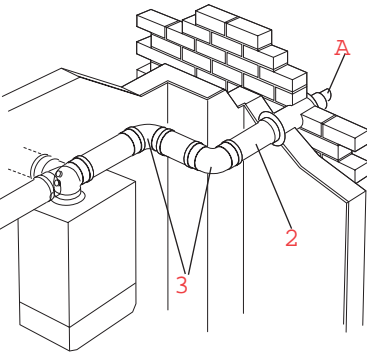
STANDARD HORIZONTAL EXTENDED FLUE	MODEL	MAX FLUE LENGTH (m)	DESCRIPTION OF PARTS REQUIRED	PART NUMBER
	ALL	3.5m*	A Standard Horizontal Flue Kit B 1m Extension Pipe (as required) C 90° Bends (as required)	A2024800 08545200 08545400
*For each 90° bend fitted the maximum flue length must be reduced by 1 metre				

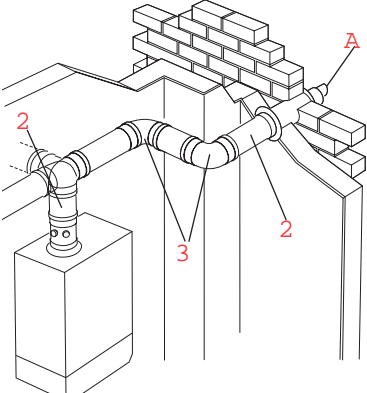
STANDARD HORIZONTAL ELEVATED FLUE	MODEL	MAX FLUE LENGTH (m)	DESCRIPTION OF PARTS REQUIRED	PART NUMBER
	ALL	3.5m*	A Standard Horizontal Flue Kit B 1m Extension Pipe (as required) C 90° Bends (as required)	A2024800 08545200 08545400
*For each 90° bend fitted the maximum flue length must be reduced by 1 metre				

## VERTICAL FLUE OPTIONS

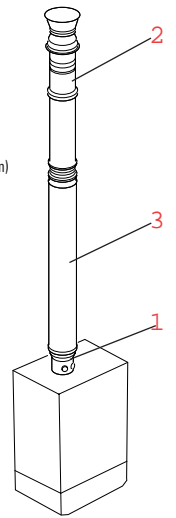
STRAIGHT	MODEL	MAX FLUE LENGTH (M)	DESCRIPTION OF PARTS REQUIRED	PART NUMBER
 NOTE: Total length of roof terminal (08510300) is 1195mm. Maximum length of section inside roof space is approx. 500mm (assuming thickness of roof = 75mm)	ALL	8m*	A Vertical Flue Adaptor Kit B Roof Terminal C 1m Extension Pipe (as required)	A2024900 08510300 08509900
*Plus the Terminal assembly				

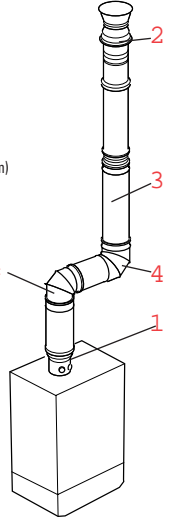
90° BENDS	MODEL	MAX FLUE LENGTH (M)	DESCRIPTION OF PARTS REQUIRED	PART NUMBER
 NOTE: Total length of roof terminal (08510300) is 1195mm. Maximum length of section inside roof space is approx. 500mm (assuming thickness of roof = 75mm)	ALL	8m*	A Vertical Flue Adaptor Kit B Roof Terminal C 1m Extension Pipe (as required) 4 90° Bends (as required)	A2024900 08510300 08509900 08510100
*For each 90° bend or 2 x 45° bends fitted the maximum flue length must be reduced by 1 metre				

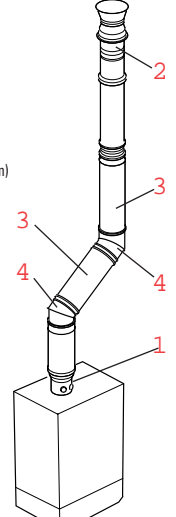
45° BENDS	MODEL	MAX FLUE LENGTH (M)	DESCRIPTION OF PARTS REQUIRED	PART NUMBER
 NOTE: Total length of roof terminal (08510300) is 1195mm. Maximum length of section inside roof space is approx. 500mm (assuming thickness of roof = 75mm)	ALL	8m*	A Vertical Flue Adaptor Kit B Roof Terminal C 1m Extension Pipe (as required) 4 45° Bends (as required)	A2024900 08510300 08509900 08510200
*For each 90° bend or 2 x 45° bends fitted the maximum flue length must be reduced by 1 metre				

## TWIN FLUE OPTIONS

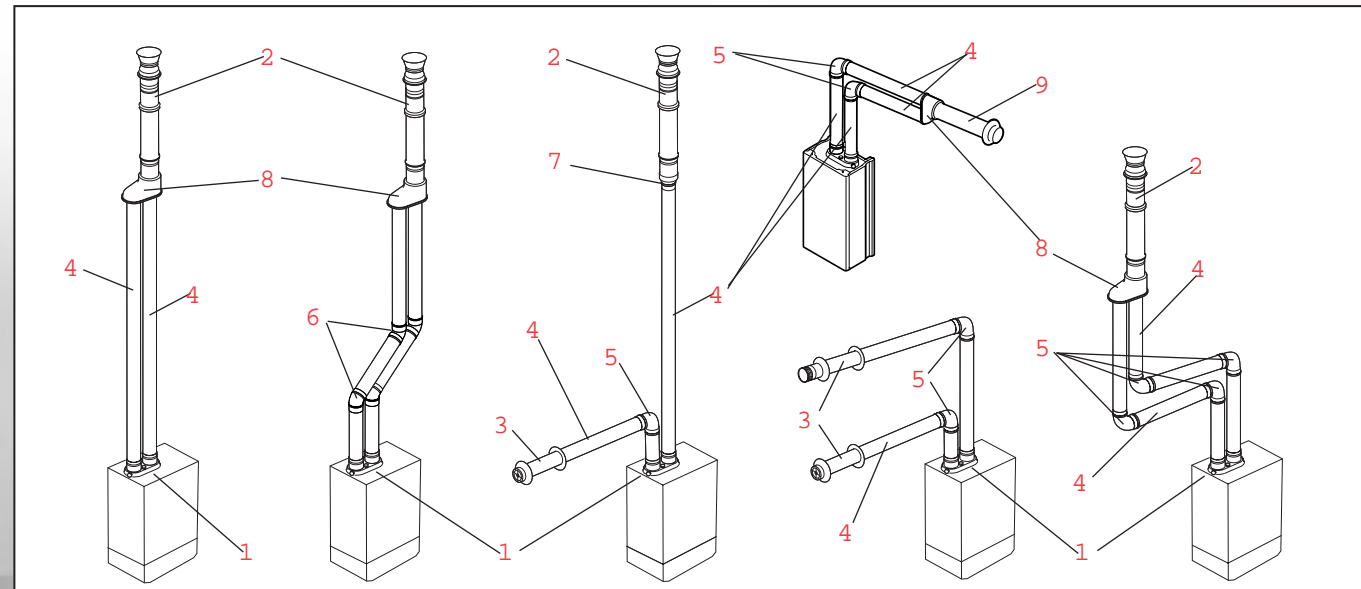

MODEL	MAX FLUE LENGTH (m)	DESCRIPTION OF PARTS REQUIRED	PART NUMBER
ALL	20 metres	<b>A</b> Twin Flue Adaptor Kit <b>2</b> Roof Terminal <b>3</b> Horizontal Twin Flue Terminals <b>4</b> 1m Extension Pipe <b>5</b> 90° Bends (as required)* <b>6</b> 45° Bends (as required)* <b>7</b> Single Pipe to Terminal Adaptor <b>8</b> Twin Pipe to Concentric Adaptor <b>9</b> Concentric Horizontal Terminal	A2025000 08510300 08511500 08547800 08538700 08538800 08511900 08511800 08584900

NOTE: Maximum 20 metres combined air and flue ducting. (eg. 10 metres air + 10 metres flue = 20 metres).  
 Total length of roof terminal (08510300) is 1195mm.  
 Maximum length of section inside roof space is approx 500mm (assuming thickness of roof = 75mm).  
 \*Plus the Terminal assembly and a maximum of 4 x 90° bends or alternatively 8 x 45° bends.

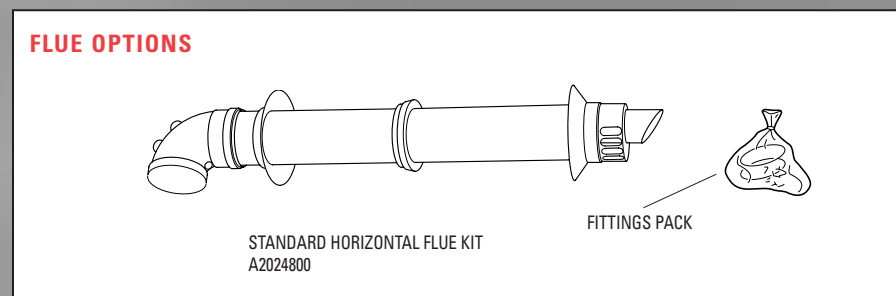
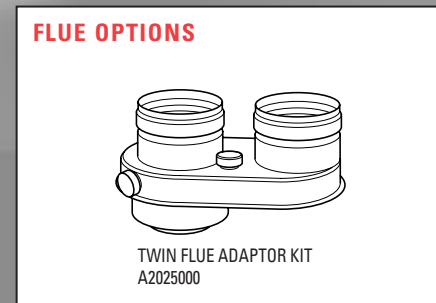
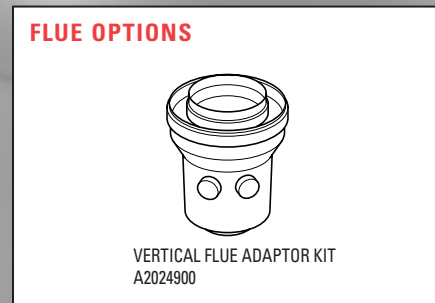
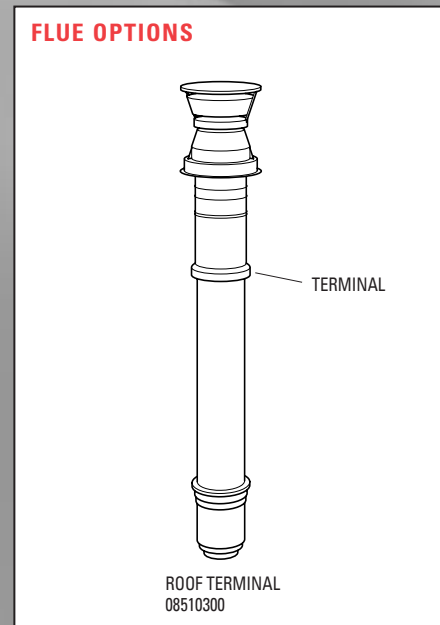

## ACCESSORIES

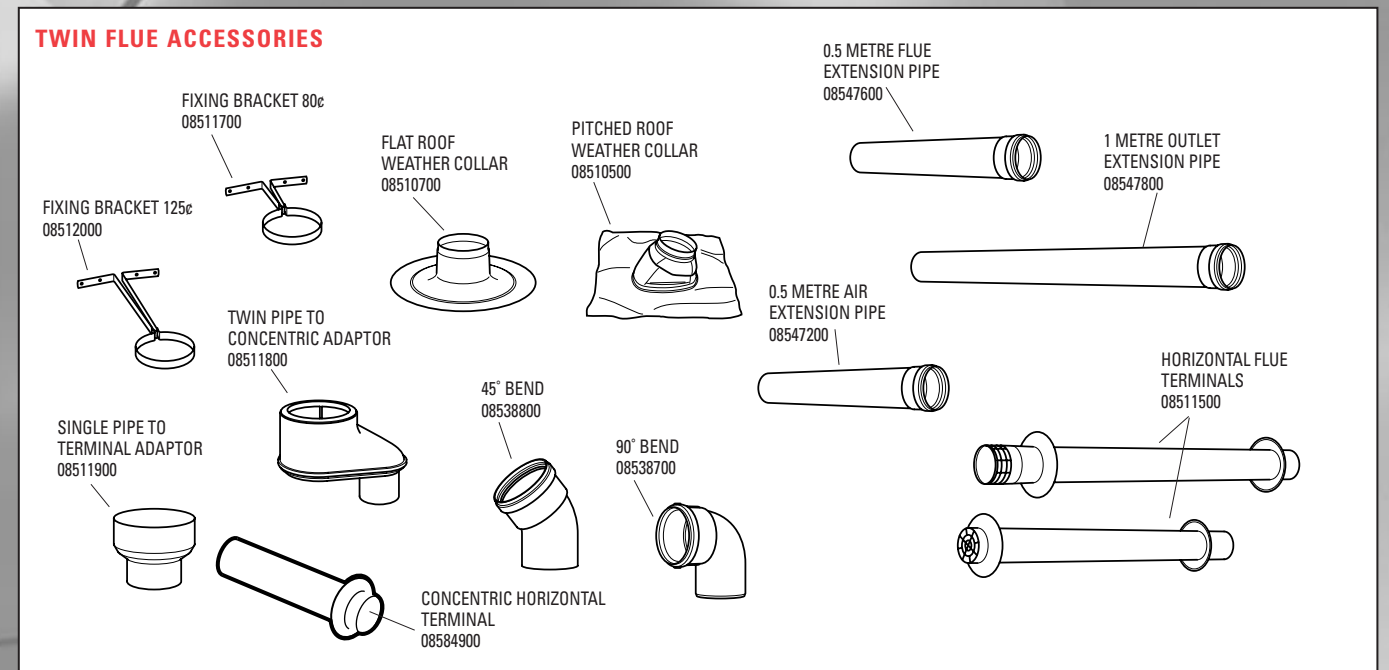
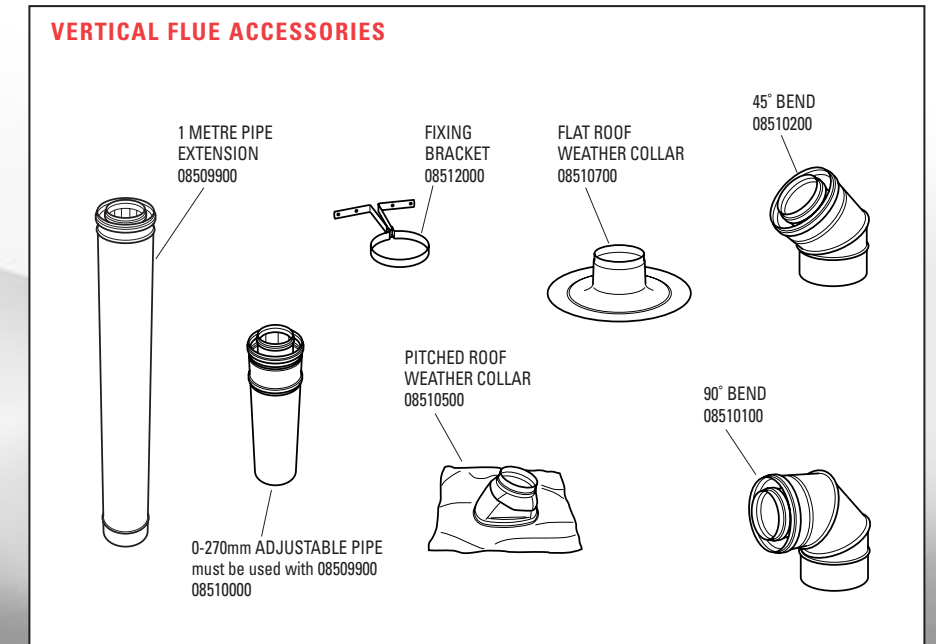
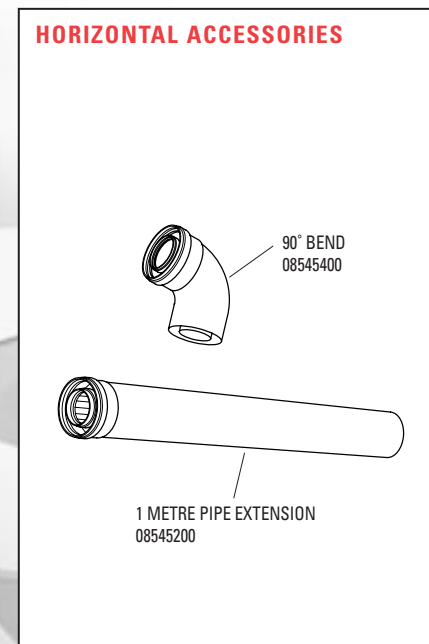

## HORIZONTAL FLUE OPTIONS models 40-80FF

### STANDARD HORIZONTAL FLUE

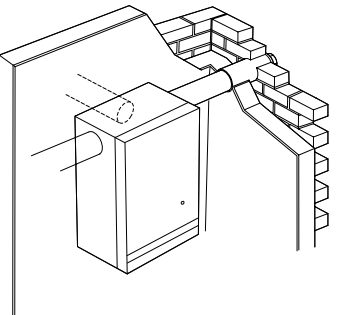
	MODEL	MAX LENGTH OF STANDARD PACK	DESCRIPTION OF PART REQUIRED	PART NUMBER
	40FF	510mm	Standard Flue Pack (Complete with Flue / Air Duct)	900858
	50FF	510mm		
	60FF	510mm		
	80FF	510mm		

### EXTENDED HORIZONTAL FLUE

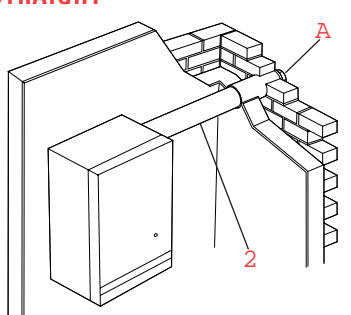
<b>STRAIGHT</b> 	MODEL	MAX FLUE LENGTH (m)	DESCRIPTION OF PARTS REQUIRED	PART NUMBER
	40FF	3m	A Terminal Pack	2000448473
	50FF	3m	B 1m Flue / Air Duct Kit or	2000448490
	60FF	3m	B 2m Flue / Air Duct Kit or	2000448491
	80FF	3m	B 3m Flue / Air Duct Kit	2000448485

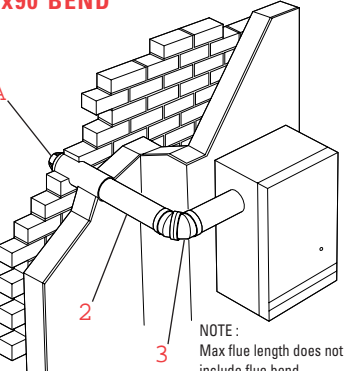
<b>1x90° BEND</b> 	MODEL	MAX FLUE LENGTH (m)	DESCRIPTION OF PARTS REQUIRED	PART NUMBER
	40FF	3m	A Terminal Pack (Bend) B 1m Flue / Air Duct Kit	2000448486 2000448490
	50FF	3m	or B 2m Flue / Air Duct Kit	2000448491
	60FF	3m	or B 3m Flue / Air Duct Kit	2000448485
	80FF	3m	C Flue Bend Kit (1 Required)	438130

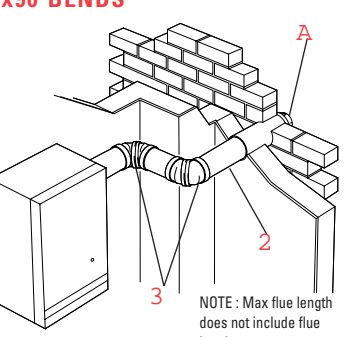
<b>2x90° BENDS</b> 	MODEL	MAX FLUE LENGTH (m)	DESCRIPTION OF PARTS REQUIRED	PART NUMBER
	40FF	3m	A Terminal Pack (Bend) B 1m Flue / Air Duct Kit	2000448486 2000448490
	50FF	3m	or B 2m Flue / Air Duct Kit	2000448491
	60FF	3m	or B 3m Flue / Air Duct Kit	2000448485
	80FF	1.2m	C Flue Bend Kit (2 Required)	438130

## HORIZONTAL FLUE OPTIONS models 40-80FF

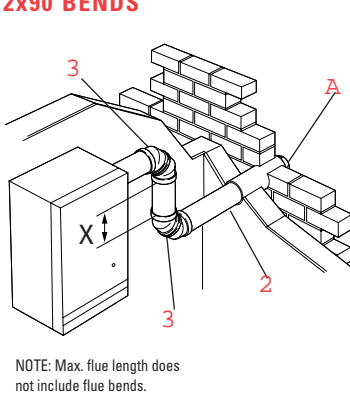
<b>2x90° BENDS</b> 	MODEL	MAX FLUE LENGTH (m)	X (MAX) (m)	DESCRIPTION OF PARTS REQUIRED	PART NUMBER
	40FF	3m	1m	A Terminal Pack (Bend) B 1m Flue / Air Duct Kit	2000448486 2000448490
	50FF	3m	1m	or B 2m Flue / Air Duct Kit	2000448491
	60FF	3m	1m	or B 3m Flue / Air Duct Kit	2000448485
	80FF	1.5m	0.5m	C Flue Bend Kit (2 Required)	438130

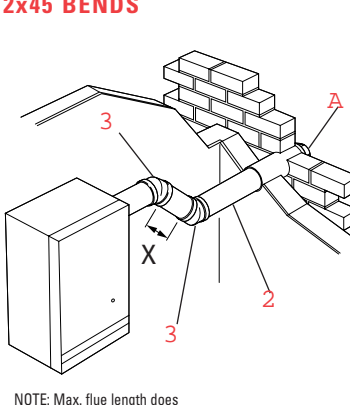
<b>2x45° BENDS</b> 	MODEL	MAX FLUE LENGTH (m)	X (MAX) (m)	DESCRIPTION OF PARTS REQUIRED	PART NUMBER
	40FF	3m	1m	A Terminal Pack (Bend) B 1m Flue / Air Duct Kit	2000448486 2000448490
	50FF	3m	1m	or B 2m Flue / Air Duct Kit	2000448491
	60FF	3m	1m	or B 3m Flue / Air Duct Kit	2000448485
	80FF	1.5m	0.5m	C Flue Bend Kit (1 Required)	438130

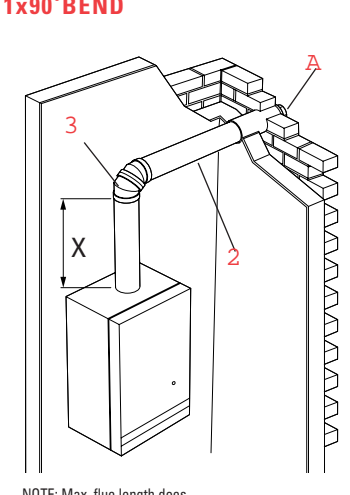
<b>1x90° BEND</b> 	MODEL	MAX FLUE LENGTH (m)	X (MAX) (m)	DESCRIPTION OF PARTS REQUIRED	PART NUMBER
	40FF	3m	2.7m	A Terminal Pack (Bend) B 1m Flue / Air Duct Kit	2000448486 2000448490
	50FF	3m	2.7m	or B 2m Flue / Air Duct Kit	2000448491
	60FF	3m	2.7m	or B 3m Flue / Air Duct Kit	2000448485
	80FF	3m	2.2m	C Flue Bend Kit (1 Required)	438130



## VERTICAL FLUE OPTIONS models 40-80FF

MODEL	MAX FLUE LENGTH (MM) X+Y+Z	DESCRIPTION OF PARTS REQUIRED	PART NUMBER
40FF	3m	A Vertical Flue Kit B Vertical Flue Terminal	2000448451 2000448494
50FF	3m	C 1m Flue / Air Duct or C 2m Flue / Air Duct	2000448490 2000448491
60FF	3m	or C 3m Flue / Air Duct	2000448485
80FF	3m		

**STRAIGHT**  
NOTE: Max. Flue Length does not include Terminal. X(Min.) = 39mm

MODEL	MAX FLUE LENGTH (MM) X+Y+Z	DESCRIPTION OF PARTS REQUIRED	PART NUMBER
40FF	1.5m	A Vertical Flue Kit B Vertical Flue Terminal C 1m Flue / Air Duct	2000448451 2000448494 2000448490
50FF	1.5m	or C 2m Flue / Air Duct	2000448491
60FF	1.5m	or C 3m Flue / Air Duct	2000448485
80FF	1m	4 Flue Bend Kit (2 Required)	438130

**2x90° BENDS**  
NOTE: Max. Flue Length does not include Terminal or Flue Bends. X(Min.) = 39mm Y(Max.) = 1000mm Y(Min.) = 0mm Z(Min.) = 0mm

MODEL	MAX FLUE LENGTH (MM) X+Y+Z	DESCRIPTION OF PARTS REQUIRED	PART NUMBER
40FF	3m	A Vertical Flue Kit B Vertical Flue Terminal C 1m Flue / Air Duct	2000448451 2000448494 2000448490
50FF	3m	or C 2m Flue / Air Duct	2000448491
60FF	3m	or C 3m Flue / Air Duct	2000448485
80FF	2m	4 Flue Bend Kit (1 Required)	438130

**2x45° BENDS**  
NOTE: Max. Flue Length does not include Terminal or Flue Bends. X(Min.) = 39mm Y(Min.) = 0mm Z(Min.) = 0mm

## EASI-VENT VERTICAL FLUE OPTIONS models 40-80FF

MODEL	MAX FLUE LENGTH (MM) X+Y+Z	DESCRIPTION OF PARTS REQUIRED	PART NUMBER
40FF	3m	A Easi-Vent Vertical Flue Terminal Kit	2000448495
50FF	3m	B 1m Flue / Air Duct or	2000448490
60FF	3m	B 2m Flue / Air Duct or	2000448491
80FF	3m	B 3m Flue / Air Duct	2000448485

**STRAIGHT**  
NOTE: Max. Flue Length does not include Terminal. (120mm High) X(Min.) = 500mm

MODEL	MAX FLUE LENGTH (MM) X+Y+Z	DESCRIPTION OF PARTS REQUIRED	PART NUMBER
40FF	1.5m	A Easi-Vent Vertical Flue Terminal Kit	2000448495
50FF	1.5m	B 1m Flue / Air Duct or	2000448490
60FF	1.5m	B 2m Flue / Air Duct or	2000448491
80FF	1.5m	B 3m Flue / Air Duct 3 Flue Bend Kit (2 Required)	2000448485 438130

**2x90° BENDS**  
NOTE: Max. Flue Length does not include Terminal (120mm High) or Flue Bends. X(Min.) = 39mm Y(Min.) = 0mm Y(Max.) = 1000mm Z(Min.) = 500mm

MODEL	MAX FLUE LENGTH (MM) X+Y+Z	DESCRIPTION OF PARTS REQUIRED	PART NUMBER
40FF	1.5m	A Easi-Vent Vertical Flue Terminal Kit	2000448495
50FF	1.5m	B 1m Flue / Air Duct or	2000448490
60FF	1.5m	B 2m Flue / Air Duct or	2000448491
80FF	1.5m	B 3m Flue / Air Duct 3 Flue Bend Kit (1 Required)	2000448485 438130

**2x45° BENDS**  
NOTE: Max. Flue Length does not include Terminal (120mm High) or Flue Bends. X(Min.) = 39mm Y(Min.) = 0mm Z(Min.) = 500mm

MODEL	MAX FLUE LENGTH (MM) X+Y+Z	DESCRIPTION OF PARTS REQUIRED	PART NUMBER
40FF	1.5m	A Easi-Vent Vertical Flue Terminal Kit	2000448495
50FF	1.5m	B 1m Flue / Air Duct or	2000448490
60FF	1.5m	B 2m Flue / Air Duct or	2000448491
80FF	1.5m	B 3m Flue / Air Duct 3 Flue Bend Kit (1 Required)	2000448485 438130

**1x90° BEND**  
NOTE: Max. Flue Length does not include Terminal (120mm High) or Flue Bend. Y(Min.) = 39mm Z(Min.) = 500mm

## FLUE OPTIONS models 40-80FF

**STANDARD FLUE PACK**  
900858

Terminal Assembly, Foam Seal, Flue Duct

**VERTICAL FLUE TERMINAL**  
2000448494

Terminal

**EASI-VENT VERTICAL FLUE PACK**  
2000448495

Terminal, Fittings Pack

**TERMINAL KIT**  
2000448473

Terminal, Fittings Pack

**FLUE BEND KIT**  
438130

45° FLUE BENDS (2), AIR DUCT TRANSITION, FITTINGS PACK, FLUE DUCT TRANSITION

**FLUE BEND TERMINAL KIT**  
2000448486

Terminal, Fittings Pack

### ACCESSORIES

**VERTICAL FLUE**

SUPPORT ASSEMBLY 2000208591, FIRE STOP PLATE 2000208592, CEILING COLLAR 2000208590, CEILING PLATE 2000208593, WALL BAND 2000208594

**WEATHER COLLARS**

STANDARD VERTICAL FLUE  
 FLAT ROOF - Part Number 2000208596\*  
 PITCHED ROOF - FOR TILES Part Number 2000208600\*  
 FOR SLATE Part Number 2000208595\*

EASI-VENT VERTICAL FLUE  
 FLAT ROOF - RITE VENT Part Number 015203\*  
 SELKIRK Part Number 2803804\*  
 PITCHED ROOF - RITE VENT Part Number 015103\*  
 SELKIRK Part Number 2803504\*

\*Note: With appropriate storm collars

## HORIZONTAL FLUE OPTIONS model 100/120FF only

**VERTICAL FLUE PACK**  
2000448451

AIR DUCT ADAPTOR, FLUE DUCT CONNECTOR, FLUE DUCT ADAPTOR, PILOT SHIELD, RESTRICTOR 30 & 60FF, RESTRICTOR 70 & 80FF, ROOF PLATE, PIPE CLIP, FITTINGS PACK

**1M EXTENSION KIT** 2000448490  
**2M EXTENSION KIT** 2000448491  
**3M EXTENSION KIT** 2000448485

AIR DUCT, FITTINGS PACK

**HORIZONTAL FLUE AND VERTICAL FLUE**

FLUE COLLAR 443286, FLUE CONNECTOR 447994, WALL LINER 900862

### STANDARD HORIZONTAL FLUE

MODEL	MAX LENGTH OF STANDARD PACK	DESCRIPTION OF PARTS REQUIRED	PART NUMBER
100/120FF	510mm	Standard Flue Pack (Complete with Flue / Air Duct Kit)	2000448901

### EXTENDED HORIZONTAL FLUE

**STRAIGHT**

MODEL	MAX FLUE LENGTH (m)	DESCRIPTION OF PARTS REQUIRED	PART NUMBER
100/120FF	2m	A Elbow / Terminal Pack B 1m Flue / Air Duct Kit or B 2m Flue / Air Duct Kit or B 3m Flue / Air Duct Kit	2000448465 2000448488 2000448489 2000448484

**1x90° BEND**

MODEL	MAX FLUE LENGTH (m)	DESCRIPTION OF PARTS REQUIRED	PART NUMBER
100/120FF	2m	A Elbow / Terminal Pack B Flue Support Kit C 1m Flue / Air Duct Kit or C 2m Flue / Air Duct Kit D 90° Flue Bend	2000448465 448697 2000448488 2000448489 448695

NOTE: Max. Flue Length does not include Flue Bend. X(Max.) = 1500mm

**1x90° BEND**

MODEL	MAX FLUE LENGTH (m)	DESCRIPTION OF PARTS REQUIRED	PART NUMBER
100/120FF	1m	A Elbow / Terminal Pack B 1m Flue / Air Duct Kit C 90° Flue Bend	2000448465 2000448488 448695

NOTE: Max. Flue Length does not include Flue Bend.

**2x45° BENDS**

MODEL	MAX FLUE LENGTH (m)	DESCRIPTION OF PARTS REQUIRED	PART NUMBER
100/120FF	1m	A Elbow / Terminal Pack B 1m Flue / Air Duct Kit C 45° Flue Bend	2000448465 2000448488 448696

NOTE: Max. Flue Length does not include Flue Bends.

## VERTICAL FLUE OPTIONS model 100/120FF only

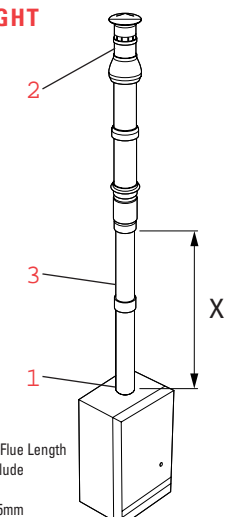
STRAIGHT	MODEL	MAX FLUE LENGTH (MM) X+Y+Z	DESCRIPTION OF PARTS REQUIRED	PART NUMBER
 <p>NOTE: Max. Flue Length does not include Terminal. X(Min.) = 105mm</p>	100/120FF	1985mm	<p><b>A</b> Vertical Flue Kit</p> <p><b>B</b> Vertical Flue Terminal</p> <p><b>C</b> 1m Flue / Air Duct Kit or</p> <p><b>C</b> 2m Flue / Air Duct Kit</p>	<p>2000448455</p> <p>2000448494</p> <p>2000448488</p> <p>2000448489</p>

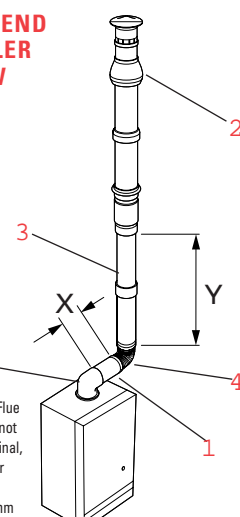
1x90° BEND & BOILER ELBOW	MODEL	MAX FLUE LENGTH (MM) X+Y+Z	DESCRIPTION OF PARTS REQUIRED	PART NUMBER
 <p>NOTE: Max. Flue Length does not include Terminal, Flue Bends or Boiler Elbow. X(Min.) = 29mm Y(Max.) = 30mm</p>	100/120FF	1m	<p><b>A</b> Vertical Flue Kit</p> <p><b>B</b> Vertical Flue Terminal</p> <p><b>C</b> 1m Flue / Air Duct Kit</p> <p><b>D</b> 90° Flue Bend</p> <p><b>E</b> Boiler Elbow Kit</p>	<p>2000448455</p> <p>2000448494</p> <p>2000448488</p> <p>448695</p> <p>2000448466</p>

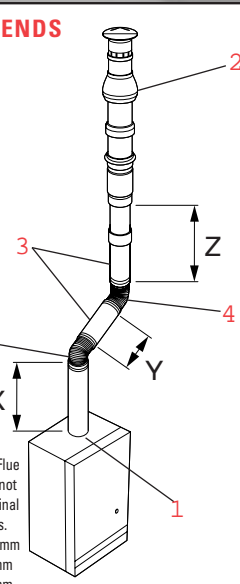
2x45° BENDS	MODEL	MAX FLUE LENGTH (MM) X+Y+Z	DESCRIPTION OF PARTS REQUIRED	PART NUMBER
 <p>NOTE: Max. Flue Length does not include Terminal or Flue Bends. X(Min.) = 102mm Y(Min.) = 27mm Z(Min.) = 30mm</p>	100/120FF	1.5m	<p><b>A</b> Vertical Flue Kit</p> <p><b>B</b> Vertical Flue Terminal</p> <p><b>C</b> 1m Flue / Air Duct Kit or</p> <p><b>C</b> 2m Flue / Air Duct Kit</p> <p><b>D</b> 45° Flue Bend</p>	<p>2000448455</p> <p>2000448494</p> <p>2000448488</p> <p>2000448489</p> <p>448696</p>

## FLUE OPTIONS ACCESSORIES model 100/120FF only

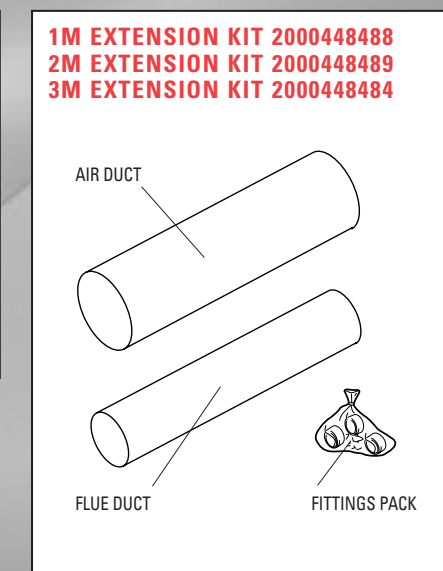
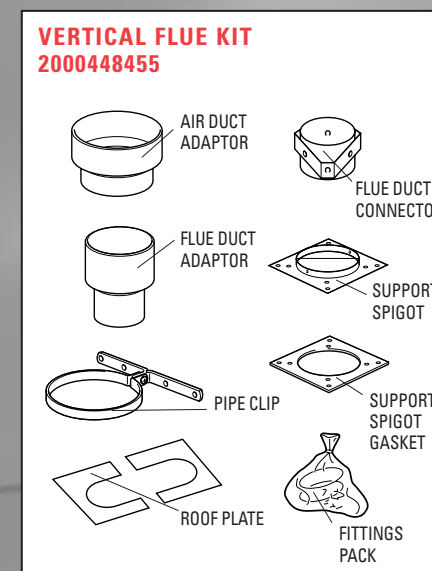
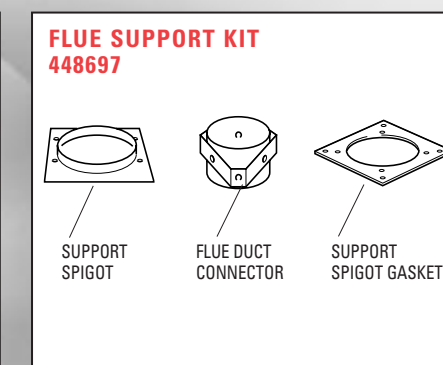
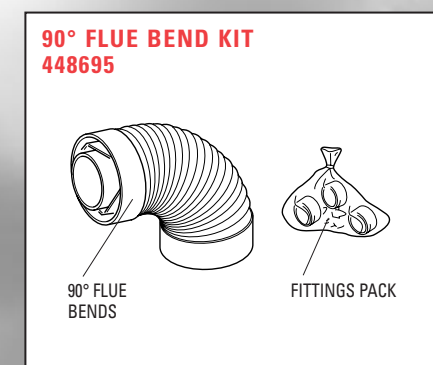
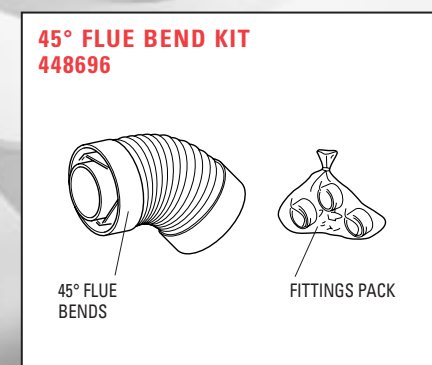
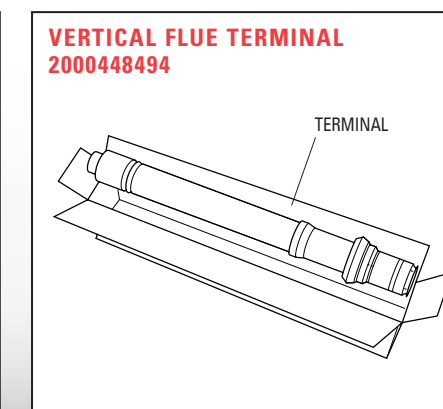
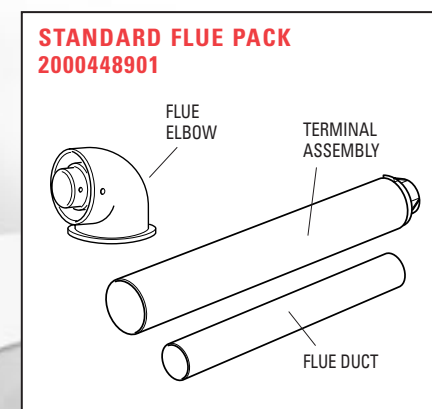

### ACCESSORIES

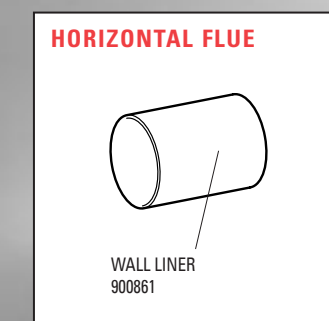
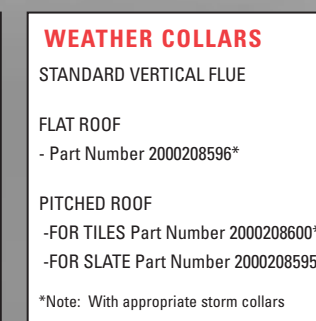
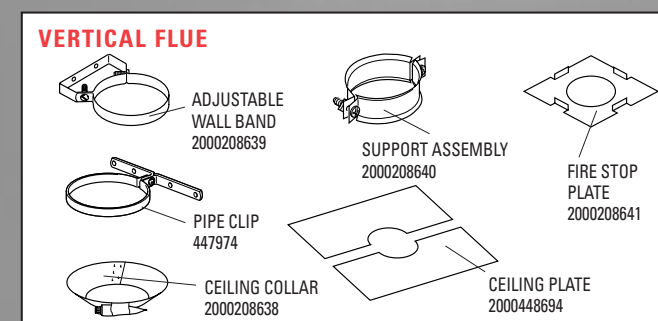



## VERTICAL FLUE ACCESSORIES model 100/120FF only

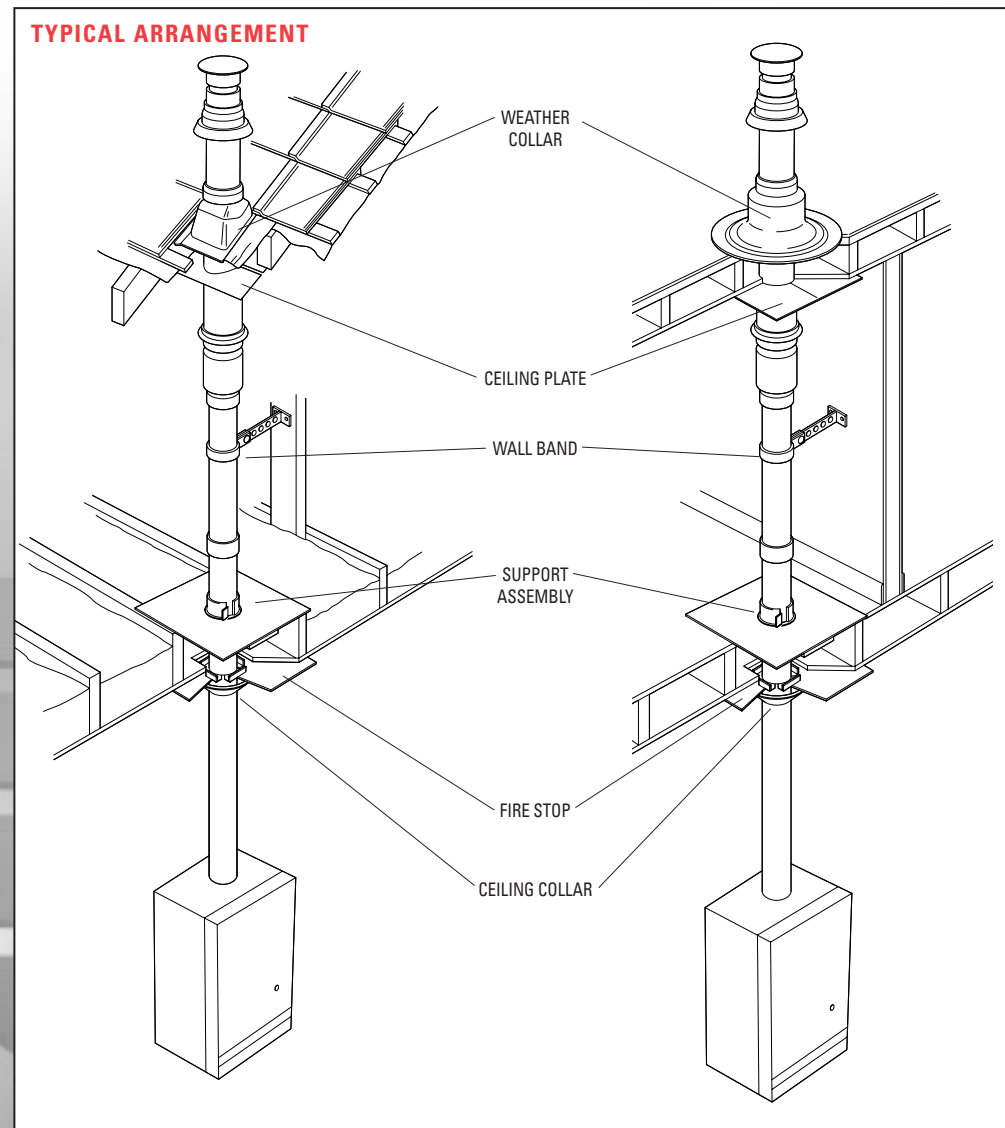

### FIRESTOP PLATE - 2000208641

Manufactured from galvanised steel and fitted with spacer lugs which ensure that a distance of 50mm is maintained between the inner liner of the flue and any combustible material.

### CEILING PLATE - 2 PIECE - 2000448694

Manufactured from galvanised steel and should be used on the under side of the floor joists where the flue passes through the floor or roof in a non-vertical plane.

### CEILING COLLAR - 2000208638

Used if required as a ceiling trim immediately below the ceiling to make a neat installation.

### SUPPORT ASSEMBLY - 2000208640

Manufacture from galvanised steel and incorporates a fire stop feature fitted with spacer lugs and support collar. This item should be used to support the flue at the top of each floor joist and provide a fire stop feature.

## TRAINING AND SUPPORT TO HELP YOU

The more you know about boilers, the faster and more efficient you become at installing them. So to help you to improve your knowledge of Saunier Duval in particular, and boilers in general, we now offer technically based courses across the UK.

Each of the one-day courses has been designed to help Corgi registered installers, and they can be tailored to suit your requirements, whether individually or as part of a group.

### The three courses are:

- 1 Basic/Performance Boilers/System (Thema Classic Range), together with specific installation information.
- 2 Advanced Combination Boiler, Isomax.
- 3 High Efficiency Condensing Boilers, based around the EnviroPLUS range, to help where preserving the environment is a primary concern.

All the courses cover installation practices, flue options, system design, commissioning, servicing and fault finding.

They are based in Scotland, Dublin, Manchester, Derby, Norwich, South Wales, London, Exeter and Bournemouth, so that wherever you are in the country, you will find one close to you.

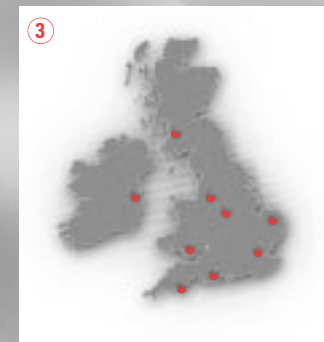

- 1 Instruction given on the removal of all components.
- 2 Commissioning instruction.
- 3 Investment in regional training facilities cuts down on travelling time for installers.

For more information, call  
Saunier Duval Training Services on  
**01773 596174**



## FANNED FLUE TERMINAL POSITIONS all models/ranges

MINIMUM SITING DIMENSIONS FOR THE POSITIONING OF FLUE TERMINALS HORIZONTAL FLUES		MM	MINIMUM SITING DIMENSIONS FOR THE POSITIONING OF FLUE TERMINALS VERTICAL FLUES		MM
A	Directly below, above or horizontally to an opening, air brick, opening windows, air vent, or any other ventilation opening	300	M	From adjacent wall to flue	300
B	Below gutter, drain/soil pipe	75	N	From another terminal	600
C	Below eaves	200	P	From adjacent opening window	1000
D	Below a balcony or car port	200	Q	Above roof level	300
E	From vertical drain pipes and soil pipes	150			
F	From internal/external corners or to a boundary alongside the terminal	300			
G	Above adjacent ground or balcony level	300			
H	From surface or a boundary facing the terminal	600			
I	Facing terminals	1200			
J	From opening (door/window) in car port into dwelling	1200			
K	Vertical from a terminal	1500			
L	Horizontal from a terminal	300			



- 4 Training on self-diagnostics is included on all courses.
- 5 Purpose designed lecture room with appliances to hand.