

OWNER GUIDE

Black Beauty Slimline

Live Fuel Effect Gas Fire



Model 341

(G. C. Number 32-032-30)

**THIS APPLIANCE IS FOR USE WITH NATURAL GAS (G20).
THIS APPLIANCE IS SUITABLE ONLY FOR INSTALLATION IN THE UNITED
KINGDOM (GB) AND THE REPUBLIC OF IRELAND (IE) ONLY.**

We trust that this Owner Guide gives sufficient details to enable the appliance to be operated and maintained satisfactorily. However, if further information is required, our **Valor Technical Helpline** will be pleased to help.

Please telephone 08706 061 065 (National call rates apply in the United Kingdom).
In the Republic of Ireland telephone **0044 8706 061 065**

This guide to be left with the owner

OWNER GUIDE

Safety First.

Valor fires are CE Approved and designed to meet the appropriate British Standards and Safety Marks.



Quality and Excellence.

At the heart of every Valor fire.

All Valor fires are manufactured to the highest standards of quality and excellence and are manufactured under a BS EN ISO 9001 quality system accepted by the British Standards Institute.



The Highest Standards

Valor is a member of the Society of British Gas Industries which works to ensure high standards of safety, quality and performance.



Careful Installation

Valor is a CORGI registered company. All our gas fires must be installed by a competent CORGI Registered Installer in accordance with our Installer Guide and should not be fitted directly on to a carpet or floor of combustible material.



Valor, Erdington, Birmingham B24 9QP

www.firesandstoves.co.uk

Because our policy is one of constant development and improvement, details may vary slightly from those given in this publication

OWNER GUIDE

LIST OF CONTENTS

<u>Section</u>	<u>Page</u>
SAFETY	3
APPLIANCE DIMENSIONS	5
GAS CONSUMPTION	5
OPERATING YOUR FIRE	6
CLEANING YOUR FIRE	8
MAINTENANCE	10
USEFUL TELEPHONE NUMBERS	11

This gas fire is designed to meet the most stringent quality, performance and safety requirements to provide you with many years' trouble-free service.

This guide aims to improve your understanding and appreciation of your gas fire by providing simple and informative instructions to ensure that you benefit from the excellent performance and features it has to offer.

SAFETY

IF YOU SMELL GAS

DON'T SMOKE

EXTINGUISH ALL NAKED FLAMES

DON'T TURN ELECTRICAL SWITCHES ON OR OFF

TURN OFF THE GAS SUPPLY AT THE METER

OPEN DOORS AND WINDOWS TO GET RID OF THE GAS

IMMEDIATELY CALL THE GAS EMERGENCY SERVICE – SEE YOUR LOCAL TELEPHONE DIRECTORY

Do have the fire installed by a competent person. In the United Kingdom, installation must be in accordance with the latest edition of the Gas Safety (installation & use) Regulations. In the Republic of Ireland, installation must be in accordance with all national and local regulations in force.

Do have the chimney swept prior to installation if it was previously used for solid fuel.

Do have the fire installed in accordance with the installer guide.

Do provide a suitable guard that complies with BS 8423 for the protection of young children, the elderly and the infirm. Such a guard is also recommended for the protection of pet animals. (Although this fire conforms to all the applicable standards, it is a heating appliance and certain parts of its surface will become hot).

Note: The glass panel supplied with the fire acts as a fireguard conforming to BS1945:1971 and satisfies the Heating Appliance (Fireguard) (Safety) Regulations 1991.

OWNER GUIDE

Do wait three minutes before attempting to relight if the fire is switched off or the flames are extinguished for any reason. (Your fire is fitted with a safety device that will automatically shut off the gas supply to the fire if, for any reason, the flames go out).

Do get advice about the suitability of any wall covering near your fire. Soft wall coverings (e.g. embossed vinyl, etc.) which have a raised pattern are easily affected by heat. They may, therefore, scorch or become discoloured when close to a heating appliance. Please bear this in mind whenever you are considering redecorating.

Do allow a minimum clearance of 70mm from the top of the appliance fascia to the underside of any shelf made from non-combustible materials. This clearance is necessary to allow the fascia to be lifted off for servicing. For a shelf made from wood or other combustible materials the minimum clearance from the top of the appliance fascia to the underside of the shelf is 150mm, for combustible shelves deeper than 150mm add 12.5mm to the clearance for every 25mm of additional shelf depth (See graph 1). Please bear this in mind if ever you add a shelf.

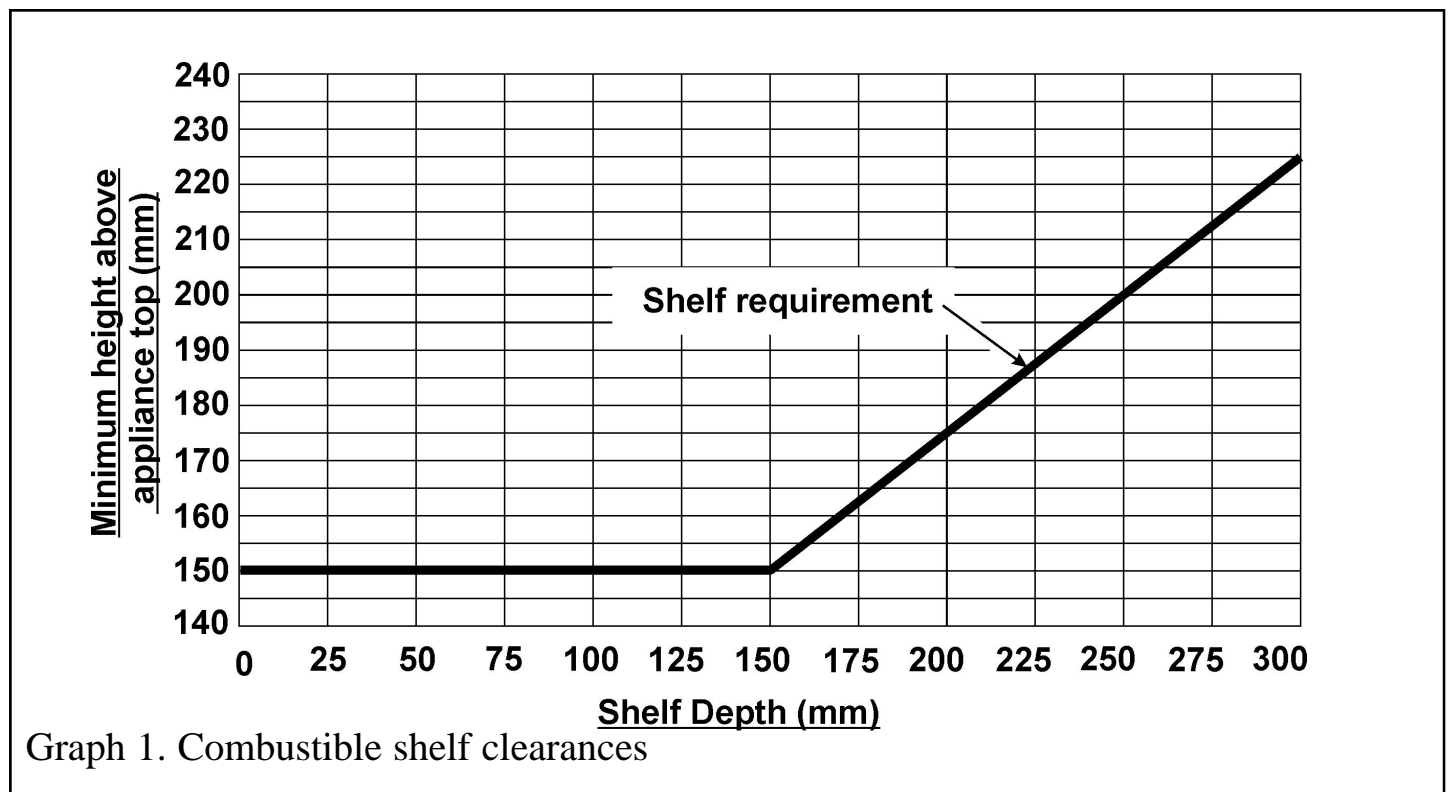

Do provide a minimum clearance of 100mm between the fascia sides and any corner wall having combustible material or other combustible surface which projects beyond the front of the fire (See figure 1). Please bear this in mind if ever you are considering altering the room.

Don't hang clothing, towels or any other fabrics over the fire.

Don't fill in the space behind the fascia.

Don't use the fire with a damaged ceramic fuel effect or with the ceramic fuel effect incorrectly positioned.

Don't use the fire if the glass window is damaged.

OWNER GUIDE

Don't attempt to clean or service the fire until it has been switched off and allowed to cool completely.

Don't allow any combustible material (e.g. Wallpaper, plastic tiling, wood panelling etc) on the surface wall below below the shelf.

APPLIANCE DIMENSIONS

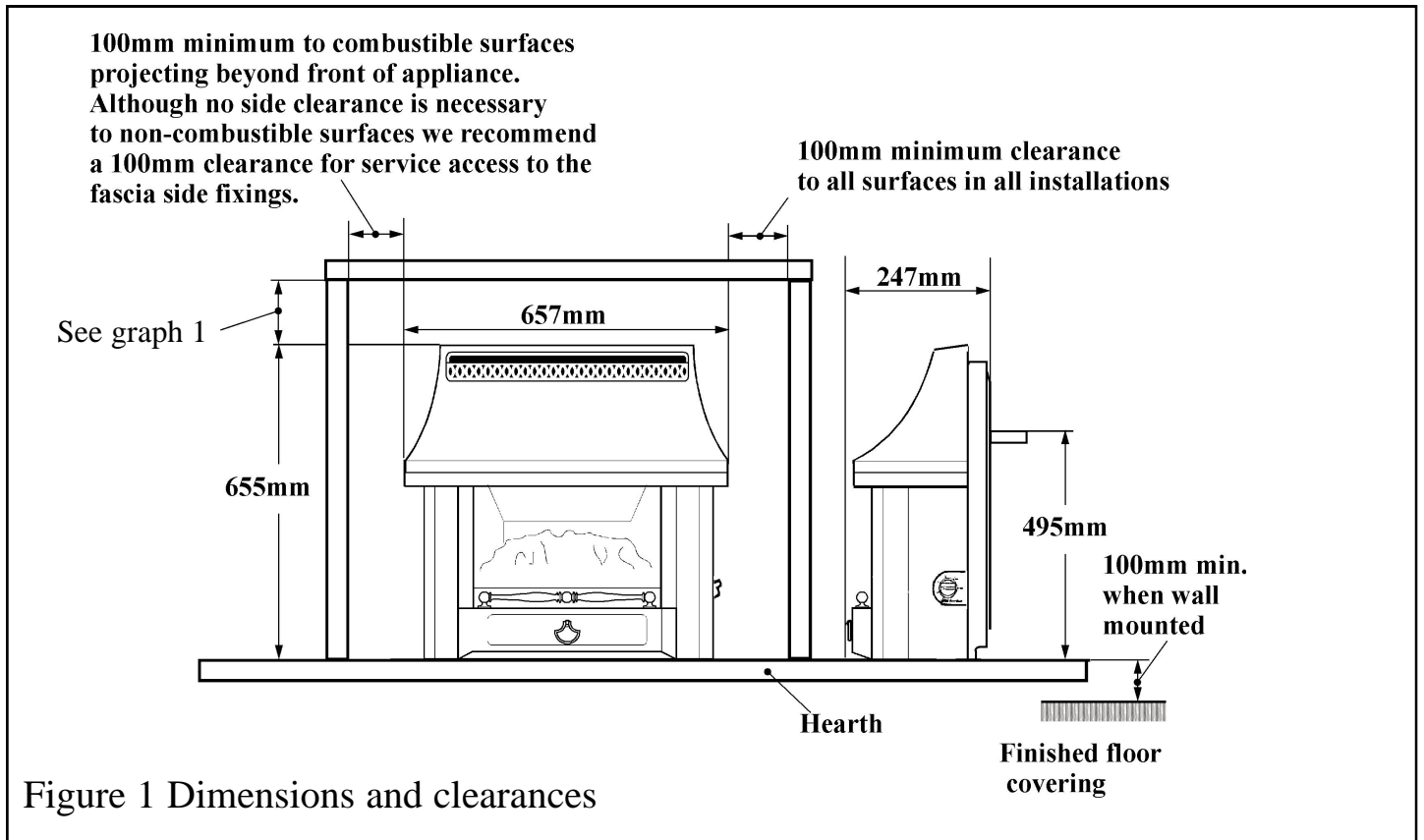

GAS CONSUMPTION

Has a maximum natural gas input of 5.6kW (Gross)

Has a maximum natural gas output of 4.0kW

Has a minimum natural gas input of 1.57kW (Gross)

Has a minimum natural gas output of 1.0kW

OWNER GUIDE

OPERATING YOUR FIRE

PLEASE NOTE

When operating your fire for the first time, some vapours may be given off which may cause a slight odour and could possibly set off any smoke alarms in the immediate vicinity. These vapours are quite normal with new appliances. They are totally harmless and will disappear after a few hours use.

The Oxysafe flame sensing and flue blockage safety system.

For your safety, this appliance is fitted with a flue blockage safety device that will shut down the appliance in the event of abnormal flue conditions. ***This device is NOT a substitute for an independently mounted Carbon Monoxide detector.***

The device will also automatically shut off the gas supply to the fire if the pilot flame goes out due to lack of oxygen or for any other reason.

If this device starts to repeatedly shut off the gas, get expert advice.

This device incorporates a probe that senses that the heat from the pilot flame is correct. If this probe is cool, the device will prevent any gas flow unless the control knob is held down at the ignition position.

If, for any reason, the flames go out when the fire is hot or if the fire is turned off when hot, always ***wait at least three minutes before attempting to relight.***

To light the fire.

The control is shown in Figure 2.

- Depress the control knob and turn partially to the 1/IGN position until you feel some resistance.
- Keep the knob depressed at this position for a few seconds to allow gas to flow to the burner.
- While keeping the knob depressed, turn to the 1/IGN position. While turning, a spark should light the pilot.
- Keep the knob depressed at the 1/IGN position for a further 10 seconds then release it. The centre section of the ceramic fuel effect will be alight at this position.
- Depress the control knob slightly and turn it to your desired burner setting.
- The control knob should be depressed slightly before turning whenever you are

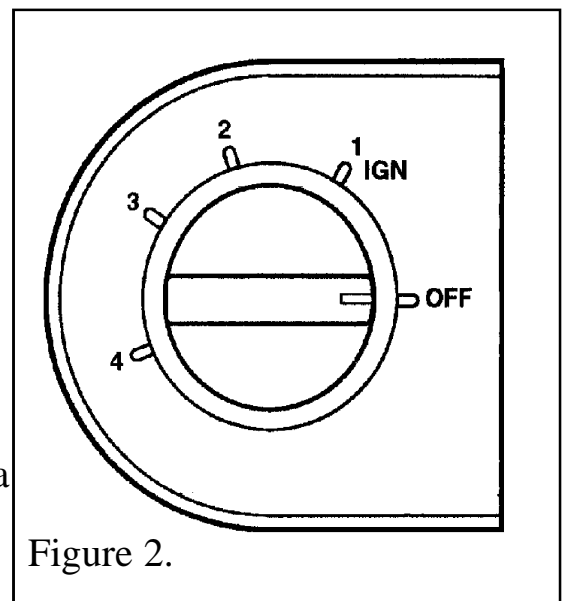

Figure 2.

OWNER GUIDE

changing the burner setting.

- The burner settings are;

Control Knob Position	Burner appearance
1 / IGN	Centre section on low. Outer sections off.
2	Centre section fully on. Outer sections off.
3	Centre section fully on. Outer sections on low.
4	All sections fully on.

- We recommend that the fire is set at position 4 for the first 10 minutes after lighting to warm up the chimney and so obtain full efficiency quickly.
- If operating the appliance for long periods it is beneficial occasionally to change the settings. This will also help to remove any carbon deposits that may form during operation.

Note: If the fire goes out while setting the control, repeat the full lighting procedure. If the fire repeatedly goes out, have the fire serviced.

To turn the fire off.

- Partially depress the control knob and turn clockwise to OFF. Release the knob.
- Wait at least 3 minutes after turning the fire off before relighting.

Lighting with a taper.

In the unlikely event of failure of the ignition spark, the pilot can be lit with a taper or long spill after the window surround has been removed. Removal of the surround is described in the "Window Glass" chapter on the next page.

Light the pilot by inserting the taper or spill below the centre of the window while the control is kept depressed at the 1/IGN position (See figure 3).

When the pilot has lit follow the rest of the instructions in the section headed "To light the fire".

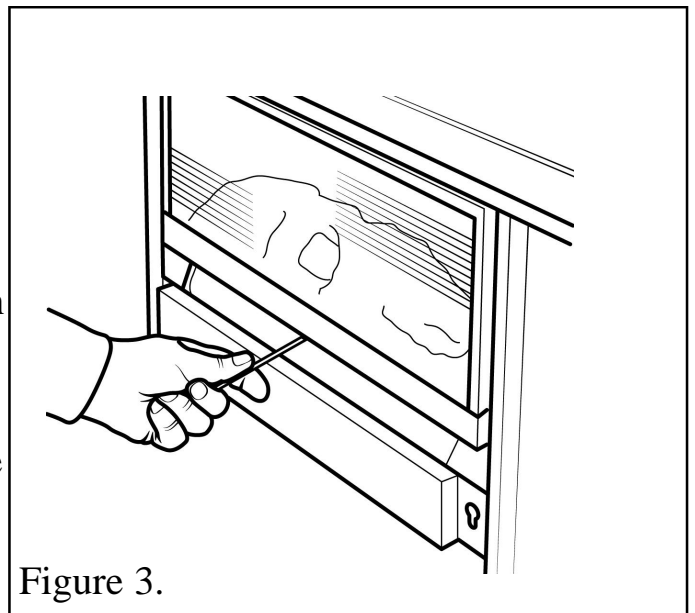

Figure 3.

OWNER GUIDE

CLEANING YOUR FIRE

To maintain the high performance and quality finish of your Valor fire, please follow these guidelines:

- Before attempting to clean the fire, please remember to turn off the fire and wait for the appliance to cool. The fire will retain heat for some time before cleaning can begin.
- If any pieces of debris are found in the fire box, have the chimney inspected before further use.

Metal parts.

- Clean the metal parts with a slightly damp cloth and then dry.
- Do not use abrasive cleaners as these will scratch the fire surface.

Window glass.

- Remove any stains on the window with a non-abrasive cleaner such as a ceramic hob cleaner. Do not use abrasive cleaners.
- The fire has been designed to so that you can remove the window without having to call in a service engineer. This allows you to clean the inside of the window.

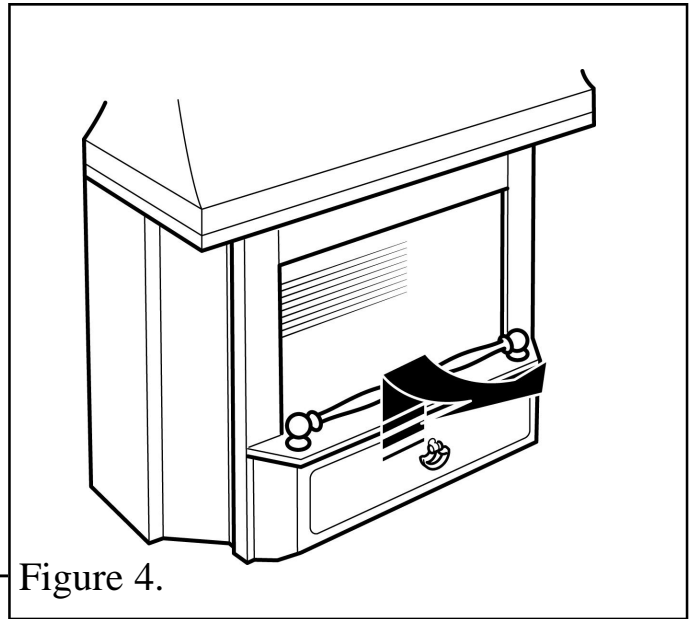

Figure 4.

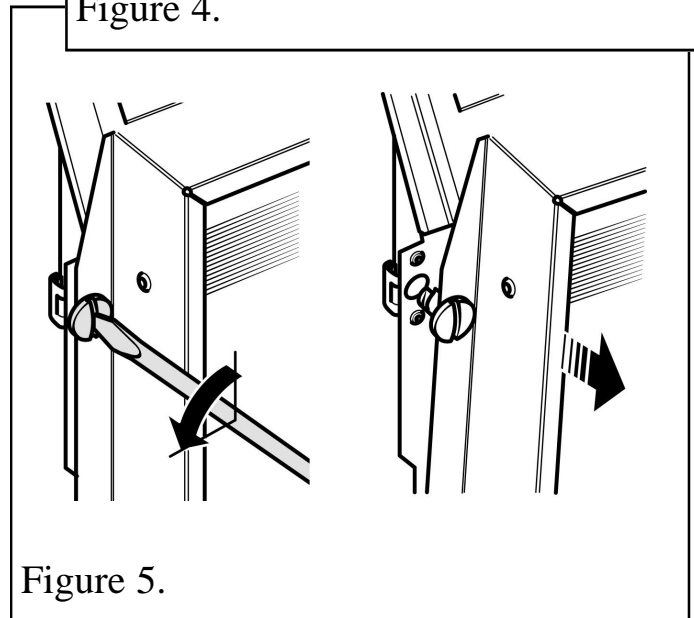

Figure 5.

To remove the window:

1. Detach the window surround by sliding it upward and then swinging the bottom forward. Lift and store carefully (See figure 4).
2. Remove the window unit by turning the screws each side of the window frame $\frac{1}{4}$ turn anticlockwise. The flattened end of the smoke match tube can act as a screwdriver. This should have been left in the information pack by the installer. Lift the window unit clear (See figure 5).

3. After cleaning, replace and secure the window unit to the firebox by turning the two screws $\frac{1}{4}$ turn clockwise with the screwdriver.

Refit the window surround by sliding the surround upward to locate its upper tabs in the slots underneath the fascia hood. Push the bottom of the surround fully against the fascia

OWNER GUIDE

cross panel. Drop the surround down so that the two screw heads at the back of the surround locate in the keyholes in the cross panel (See figure 6).

Ceramic fuel effect.

- This product uses a ceramic fuel effect containing Refractory Ceramic Fibres (RCF), which are man-made vitreous silicate fibres. Excessive exposure to this material may cause temporary irritation to eyes, skin and respiratory tract. Consequently, it makes sense to take care when handling this article to ensure that the release of dust is kept to a minimum.

- Although light coatings of soot are usually burnt off during normal use, the ceramic fuel effect may benefit from occasional cleaning.

- Should any soot accumulation become excessive, the fuel effect piece should be removed from the fire for cleaning. Cleaning should be carried out in a well ventilated area or in the open air by gently brushing with the pieces held away from your face so that you avoid inhaling the dust. We do not recommend the use of a normal domestic vacuum cleaner which may blow dust back into the air.

- The ceramic fuel effect can be lifted out of the fire box when the window surround and glass have been removed as described on page 8.

- When replacing the ceramic fuel effect, make sure that it rests on the ledges at the sides of the firebox and that its back face is touching the horizontal rib at the back of the firebox (See figure 7).

- Replace the window and surround after cleaning.

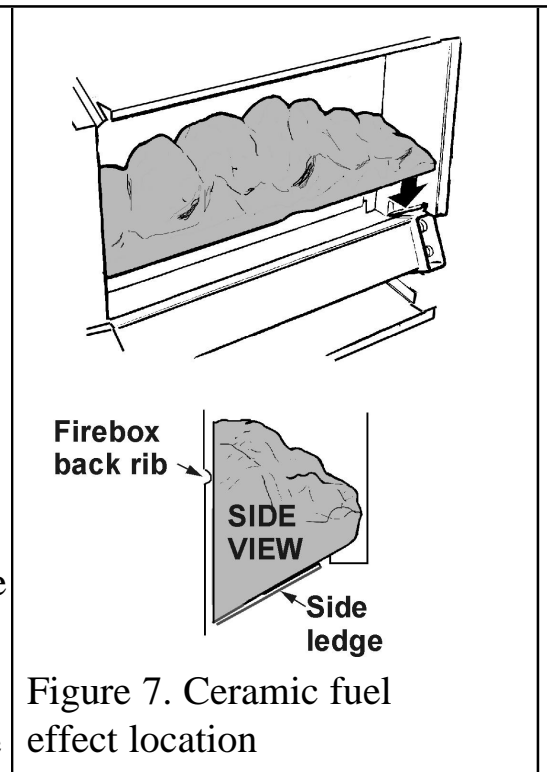
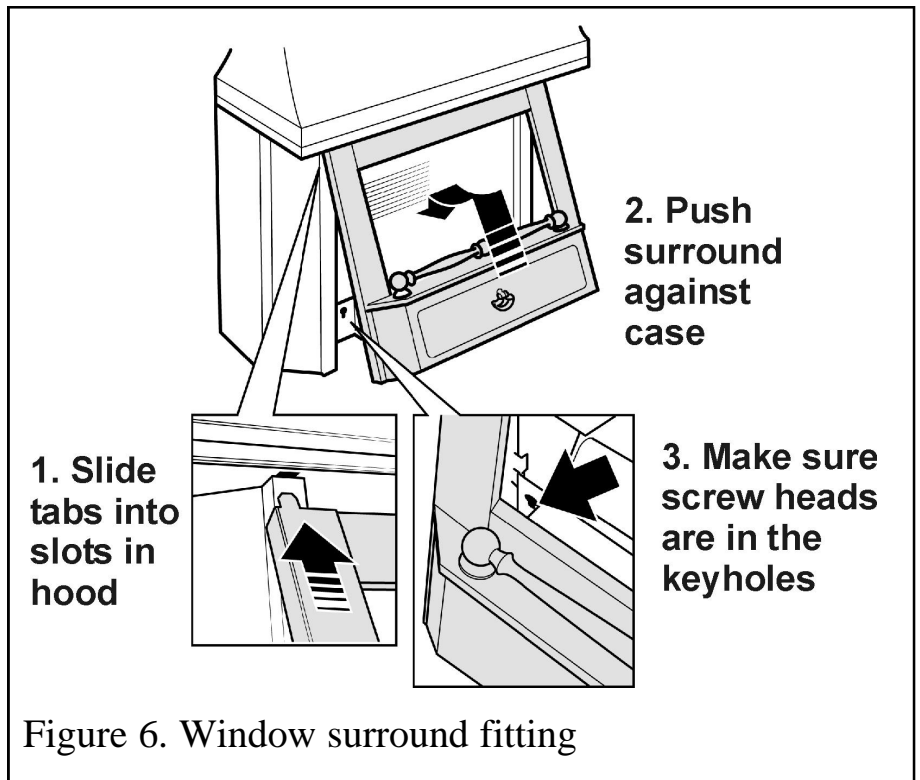

OWNER GUIDE

MAINTENANCE

Regular maintenance.

In order to achieve and maintain high levels of personal safety and performance efficiency, it is essential that the opening at the back of the fire and the flue are kept clear of any form of obstruction. It is possible that deposits of mortar or soot could fall and accumulate causing the flue to be blocked or restricted and so preventing proper clearance of dangerous exhaust fumes.

In the United Kingdom it is the law that a landlord must have any gas appliance, flue and pipework which is situated in a tenant's premises checked for safety at least every twelve months by a competent person (In the U.K., a CORGI registered installer).

We recommend that all gas appliances and their flues, wherever situated, are checked annually.

Servicing.

- In the United Kingdom servicing can be carried out either by a Valor service engineer or a CORGI registered installer.
- If you require your fire to be serviced, please contact **Valor Service** on **08706 090 081** and quote the following details;
Model name and number.
Appliance serial number (To be found on a label near the bottom left side of the fascia).
- If you wish to replace the ceramic fuel effect, spare parts are available nationwide via the '**interpart stockist network**'. For your local stockist consult Yellow pages under Central Heating.
- When fitting replacement parts, follow the instructions contained in this guide. It is important that only Valor approved parts are used for maximum safety.

OWNER GUIDE

USEFUL TELEPHONE NUMBERS

General advice about gas and your gas fire:

VALOR TECHNICAL HELPLINE 08706 061 065.

To report faults or arrange for your fire to be serviced:

VALOR SERVICE 08706 090 081.

For sales or product information:

VALOR SALES 08706 061 067.

For spares inquiries:

Spare parts are available nationwide via the ‘interpart stockist network’. For your local stockist consult Yellow pages under ‘Central Heating’.

CALLERS IN THE REPUBLIC OF IRELAND

Call 0044 8706 061 065